

# OCEAN VIEWS

RASHID YACHTS & MARINA

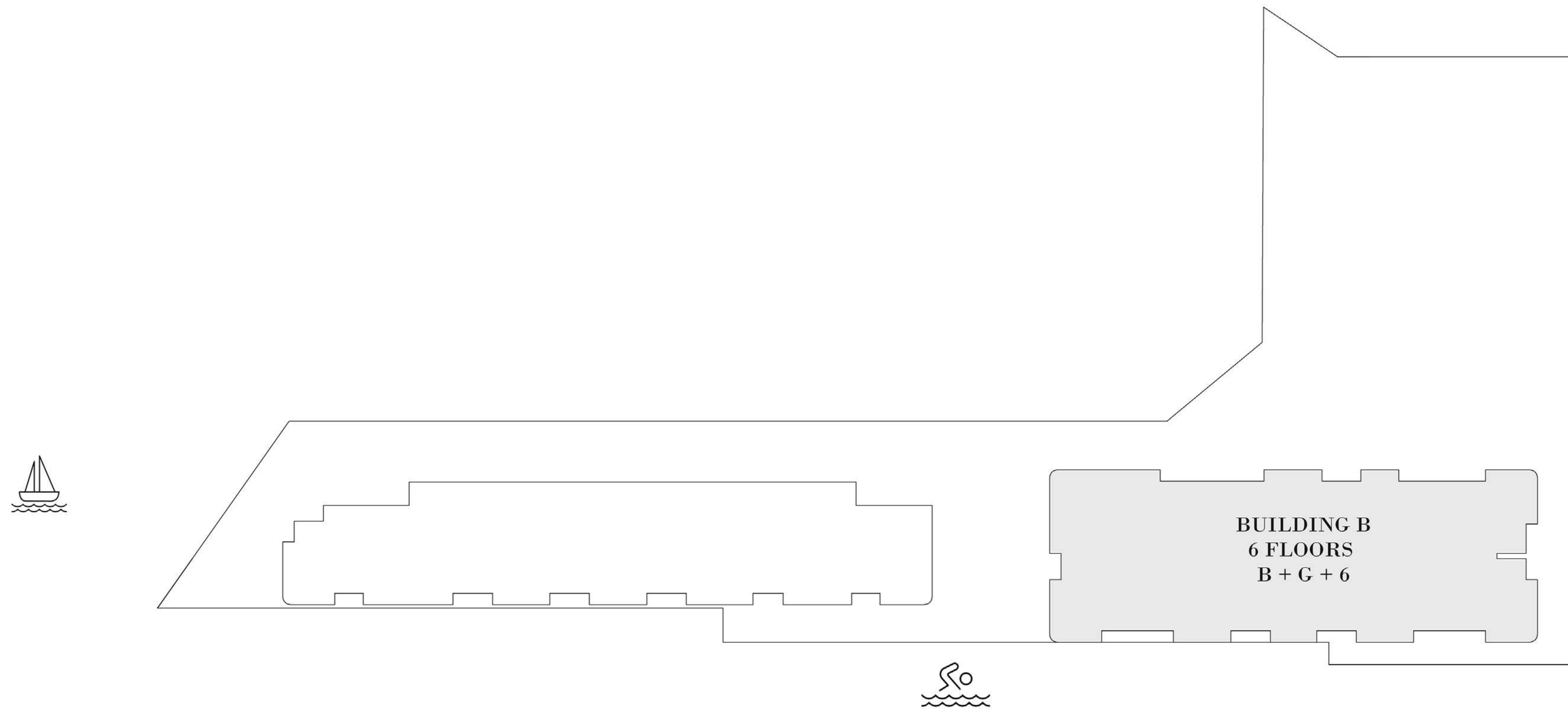

← N

Disclaimer: All dimensions are in imperials and metric, and measured from excluding construction tolerances. 2. All materials, dimensions, and drawings are approximate only. 3. Information is subject to change without notice, At developer's absolute discretion. 04. Actual area may vary from the stated area. 5. drawings not to scale. 6. All images used are for illustrative purposes only and do not represent the actual size, features, specifications, fitting, and furnishings. 7. the developer reserves the right to make revisions / alterations, at its absolute discretion, without any liability whatsoever

EMAAR

# OCEAN VIEWS

RASHID YACHTS & MARINA

## BUILDING B

### 1 BEDROOM TYPE-A1

	LEVEL 01-06	UNITS B-08
SUITE AREA	746.05 SQ.FT.	69.31 SQ.M.
BALCONY AREA	65.01 SQ.FT.	6.04 SQ.M.
TOTAL AREA	811.06 SQ.FT.	75.35 SQ.M.



KEY PLAN  
LEVEL 01-06

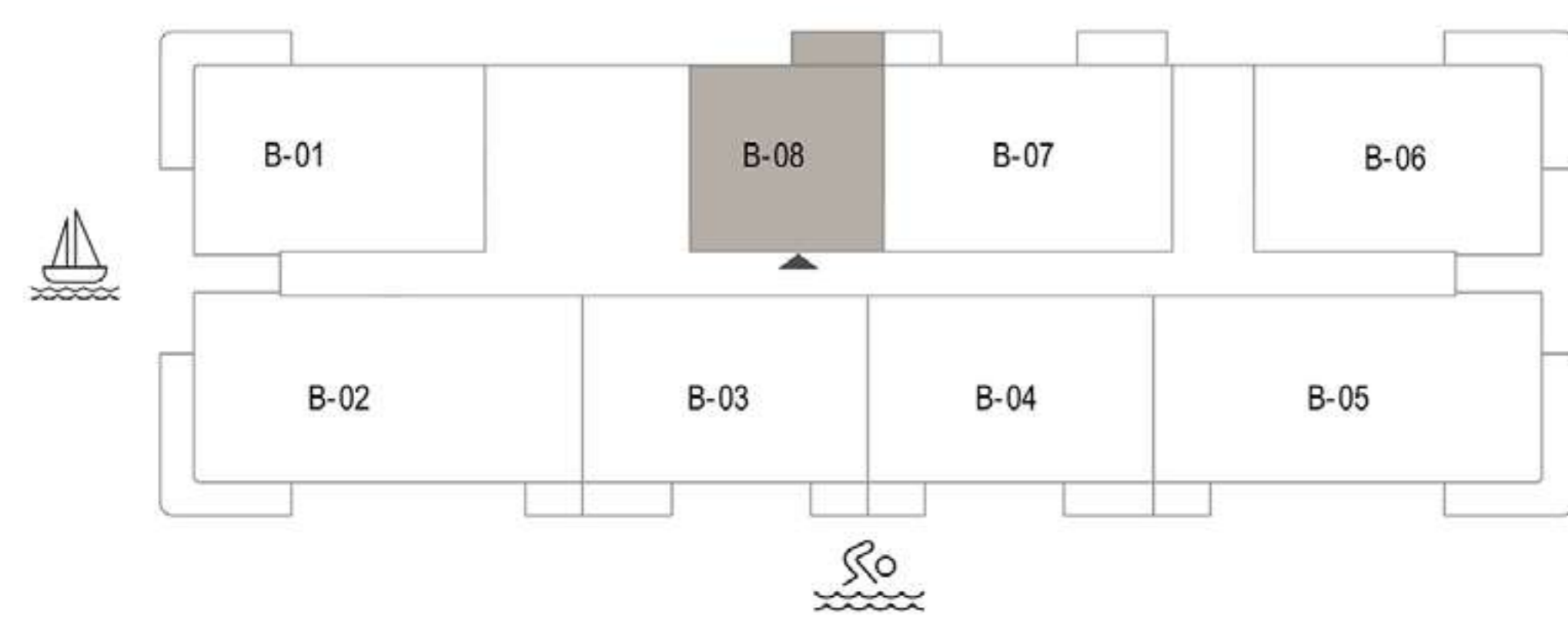

KEY SECTION

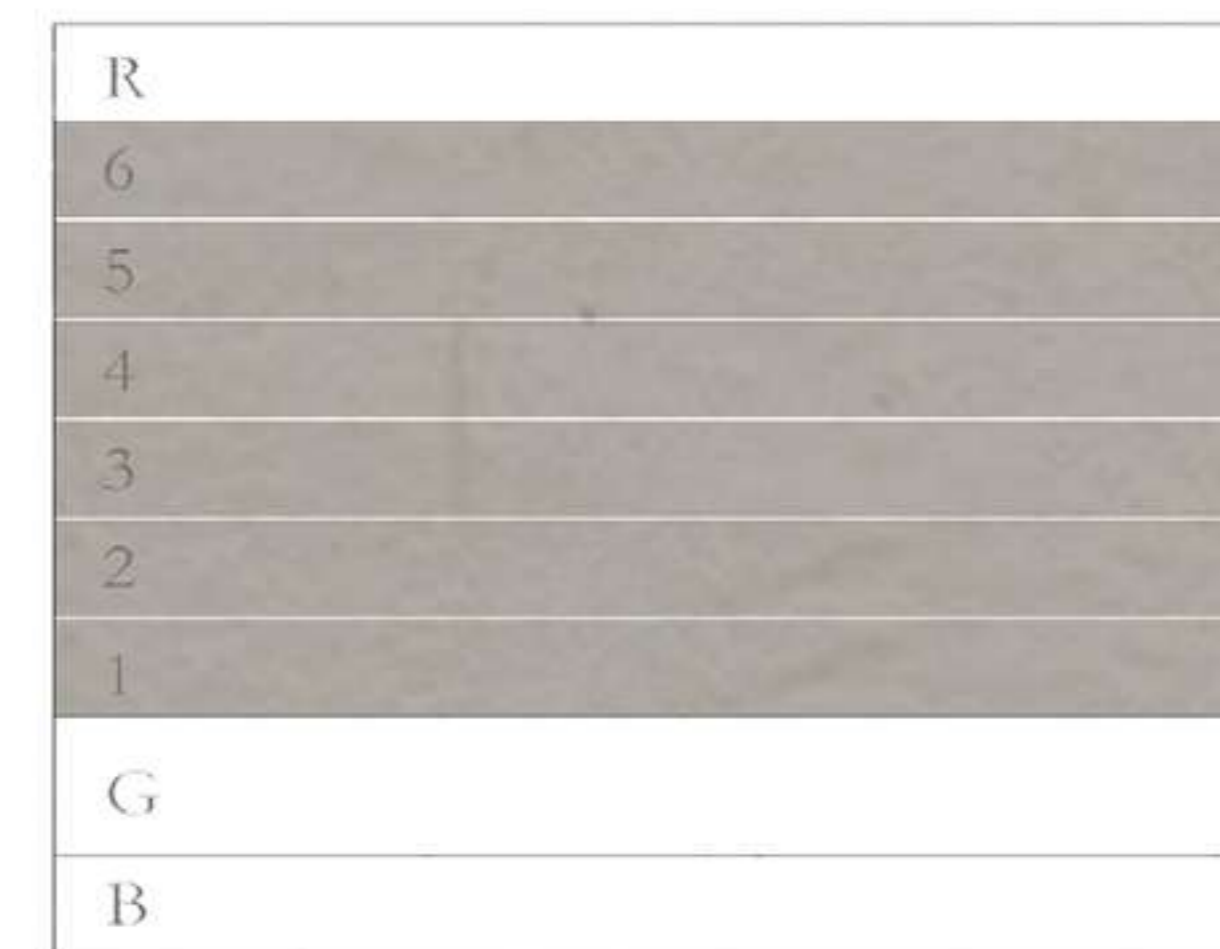

Disclaimer: All dimensions are in imperials and metric, and measured from excluding construction tolerances. 2. All materials, dimensions, and drawings are approximate only. 3. Information is subject to change without notice, At developer's absolute discretion. 04. Actual area may vary from the stated area. 5. drawings not to scale. 6. All images used are for illustrative purposes only and do not represent the actual size, features, specifications, fitting, and furnishings. 7. the developer reserves the right to make revisions / alterations, at its absolute discretion, without any liability whatsoever

# OCEAN VIEWS

RASHID YACHTS & MARINA

## BUILDING B

### 2 BEDROOM TYPE-B1

	LEVEL 01-06	UNITS B-01
SUITE AREA	1115.57 SQ.FT.	103.64 SQ.M.
BALCONY AREA	164.69 SQ.FT.	15.30 SQ.M.
TOTAL AREA	1280.26 SQ.FT.	118.94 SQ.M.

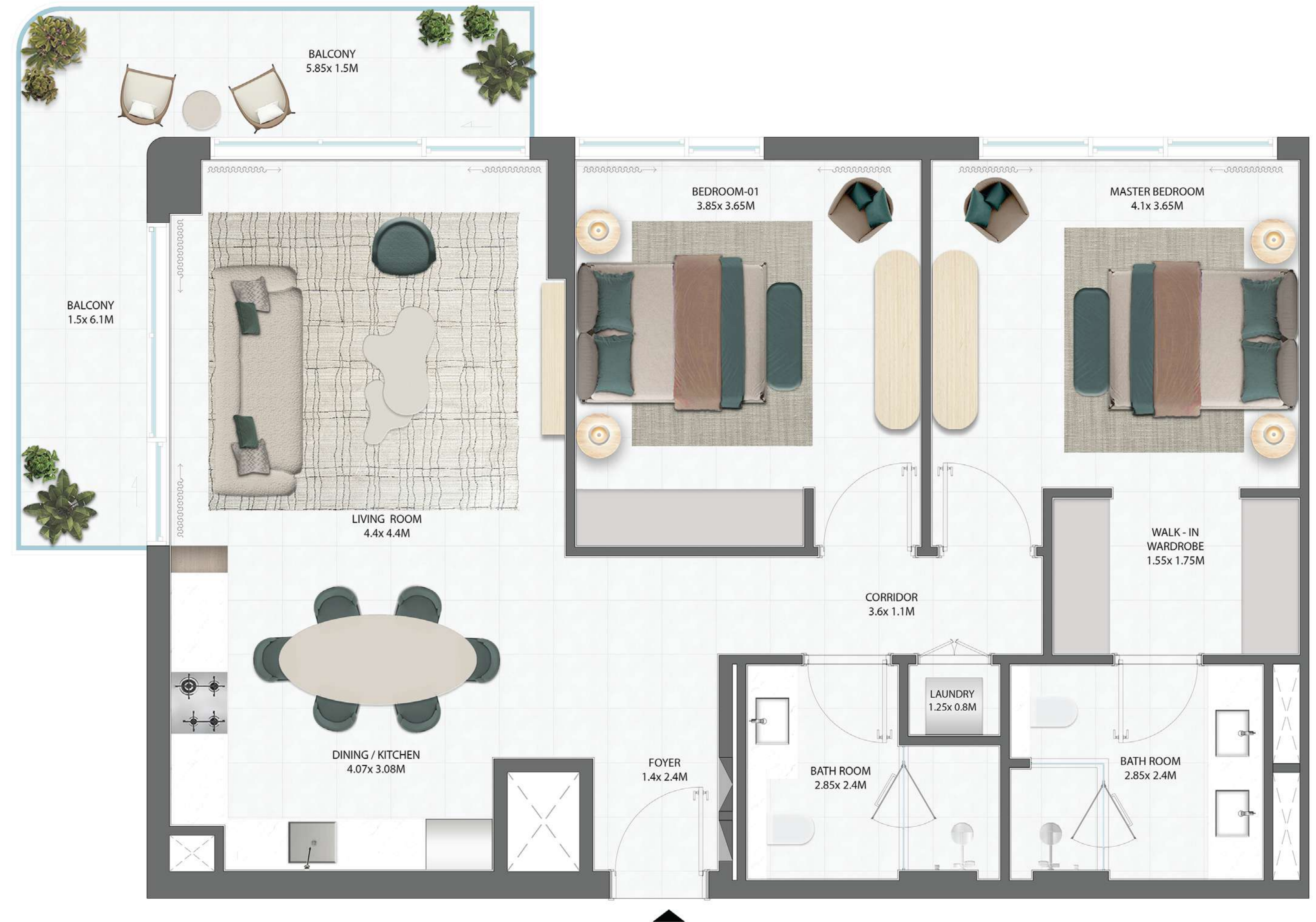

KEY PLAN LEVEL 01-06

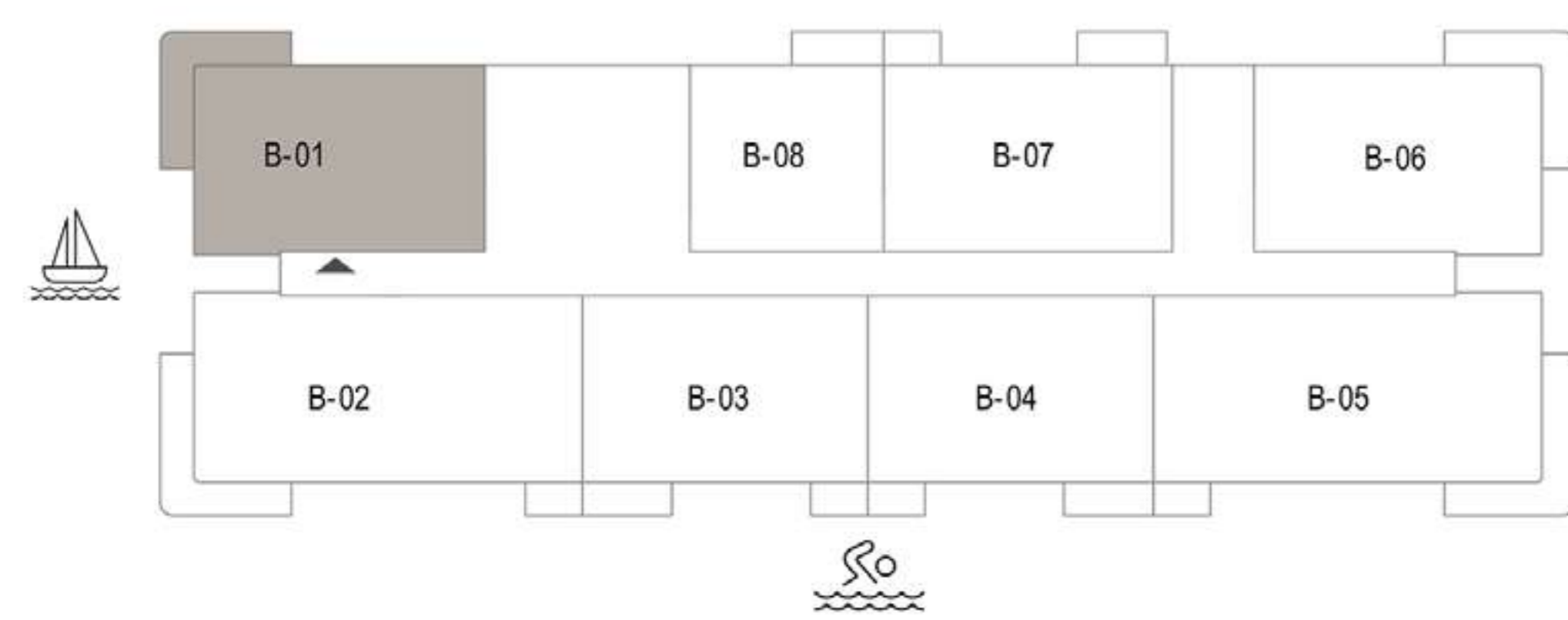

KEY SECTION

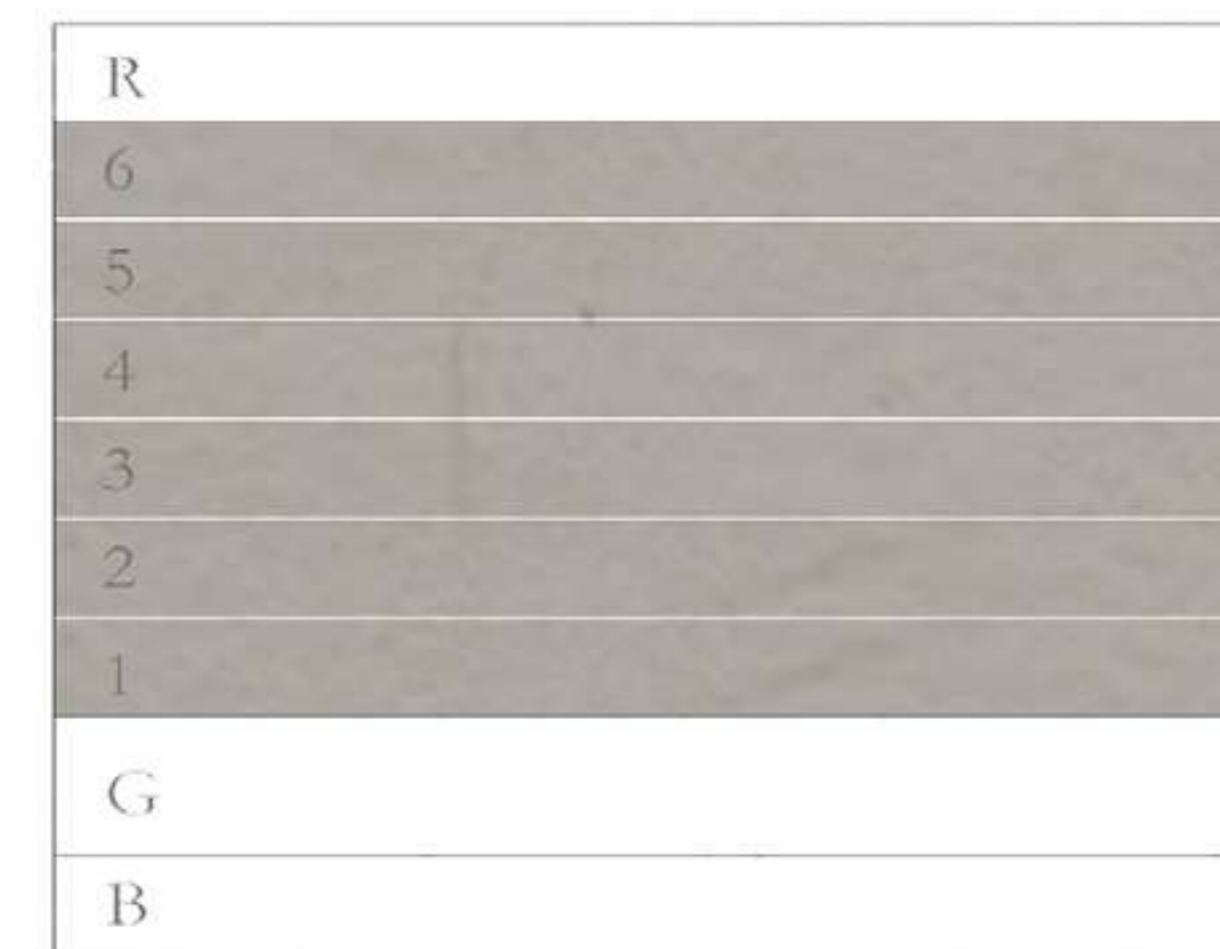

Disclaimer: All dimensions are in imperials and metric, and measured from excluding construction tolerances. 2. All materials, dimensions, and drawings are approximate only. 3. Information is subject to change without notice, At developer's absolute discretion. 04. Actual area may vary from the stated area. 5. drawings not to scale. 6. All images used are for illustrative purposes only and do not represent the actual size, features, specifications, fitting, and furnishings. 7. the developer reserves the right to make revisions / alterations, at its absolute discretion, without any liability whatsoever

# OCEAN VIEWS

RASHID YACHTS & MARINA

## BUILDING B

### 2 BEDROOM TYPE-A2

	LEVEL 01-06	UNITS B-03
SUITE AREA	1101.47 SQ.FT.	102.33 SQ.M.
BALCONY AREA	103.98 SQ.FT.	9.66 SQ.M.
TOTAL AREA	1205.45 SQ.FT.	111.99 SQ.M.



KEY PLAN  
LEVEL 01-06

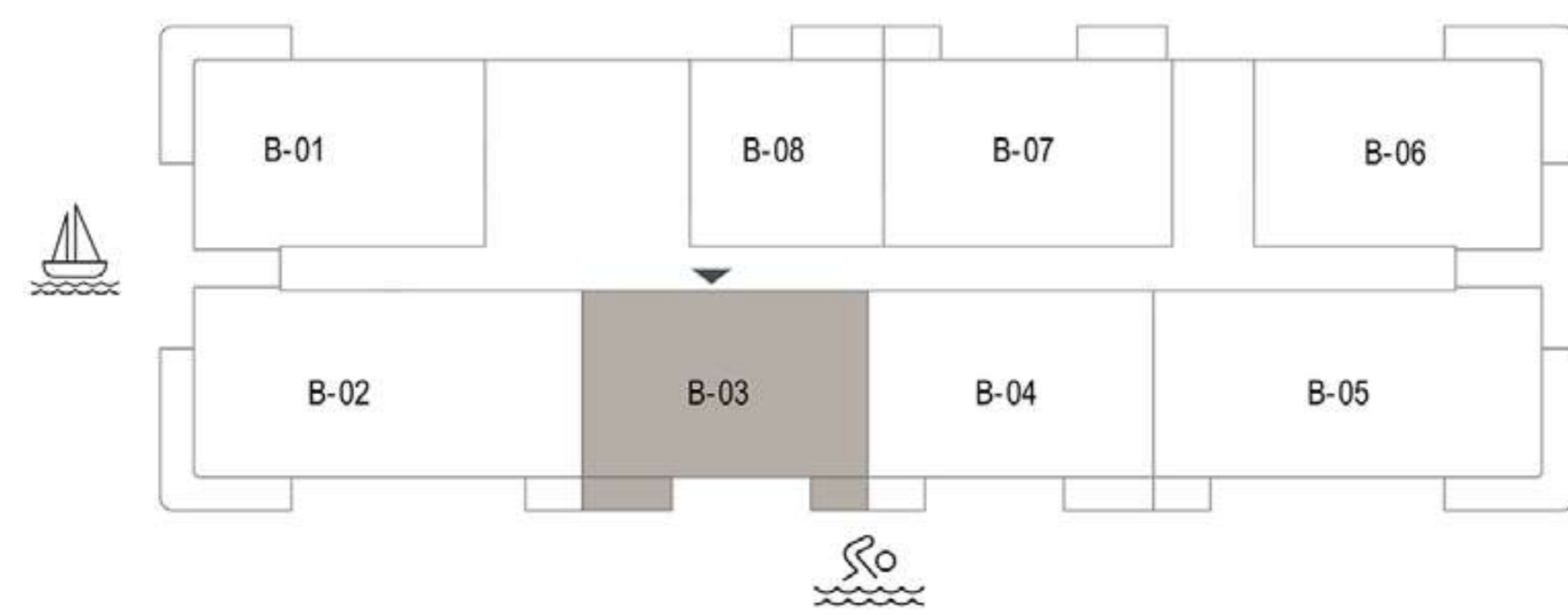

KEY SECTION

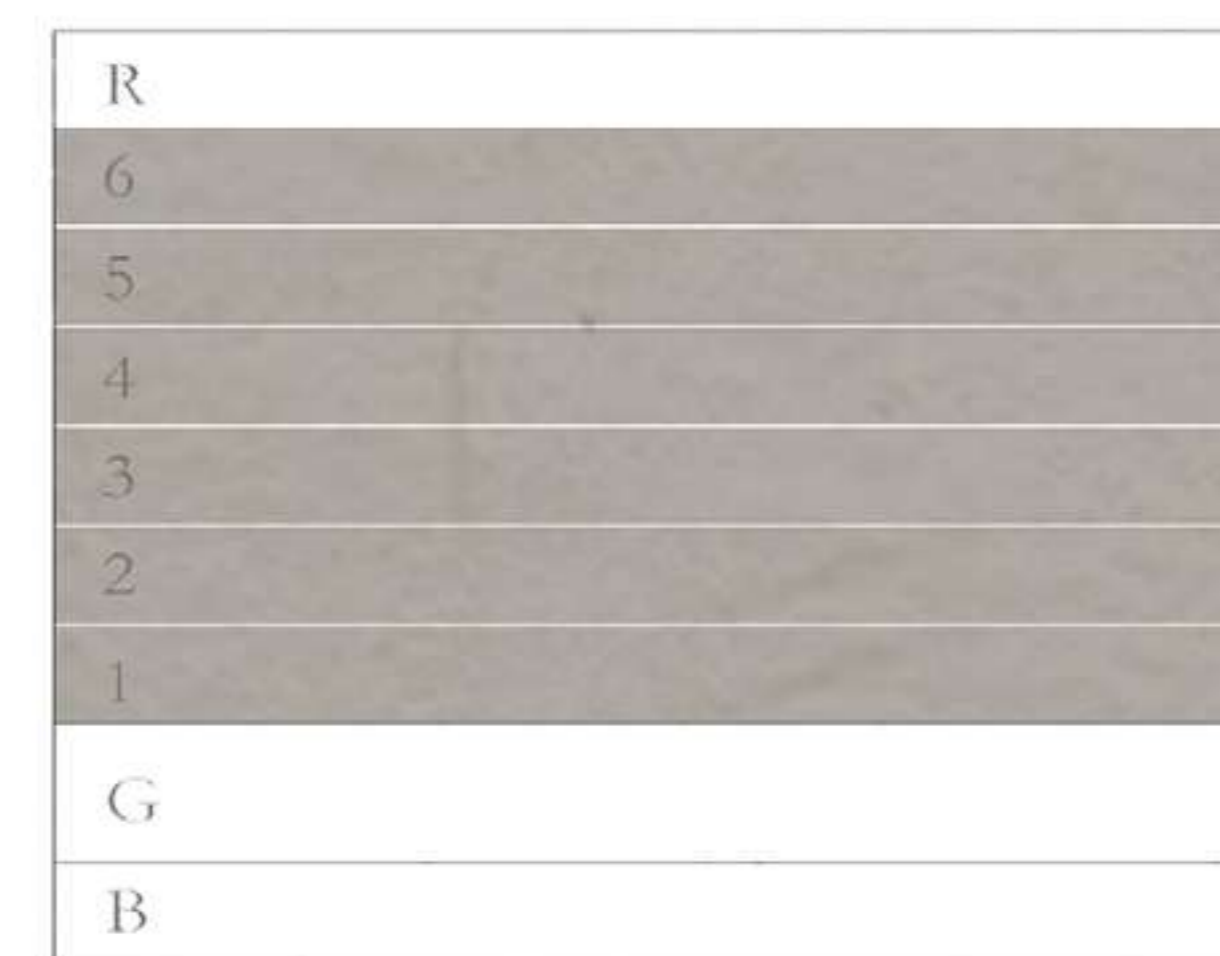

Disclaimer: All dimensions are in imperials and metric, and measured from excluding construction tolerances. 2. All materials, dimensions, and drawings are approximate only. 3. Information is subject to change without notice, At developer's absolute discretion. 04. Actual area may vary from the stated area. 5. drawings not to scale. 6. All images used are for illustrative purposes only and do not represent the actual size, features, specifications, fitting, and furnishings. 7. the developer reserves the right to make revisions / alterations, at its absolute discretion, without any liability whatsoever

# OCEAN VIEWS

RASHID YACHTS & MARINA

## BUILDING B

### 2 BEDROOM TYPE-A3

	LEVEL 01-06	UNITS B-04
SUITE AREA	1101.58 SQ.FT.	102.34 SQ.M.
BALCONY AREA	103.87 SQ.FT.	9.65 SQ.M.
TOTAL AREA	1205.45 SQ.FT.	111.99 SQ.M.



KEY PLAN  
LEVEL 01-06

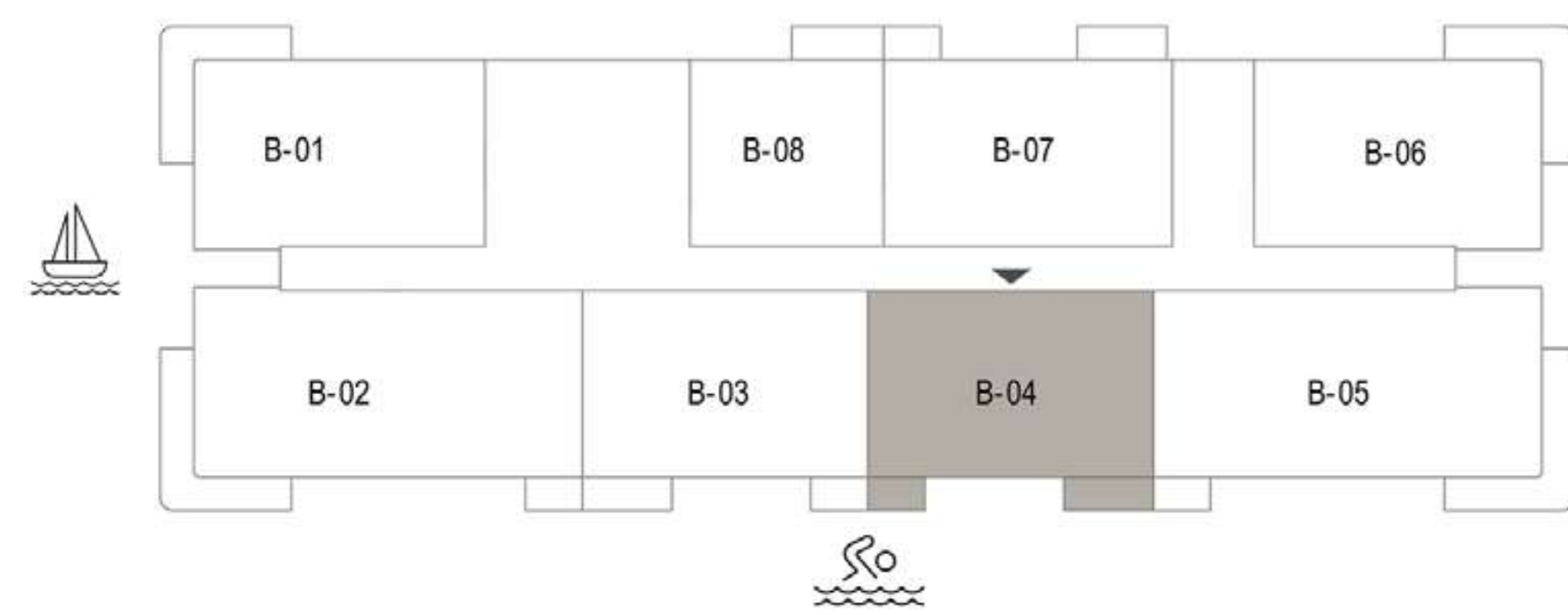

KEY SECTION

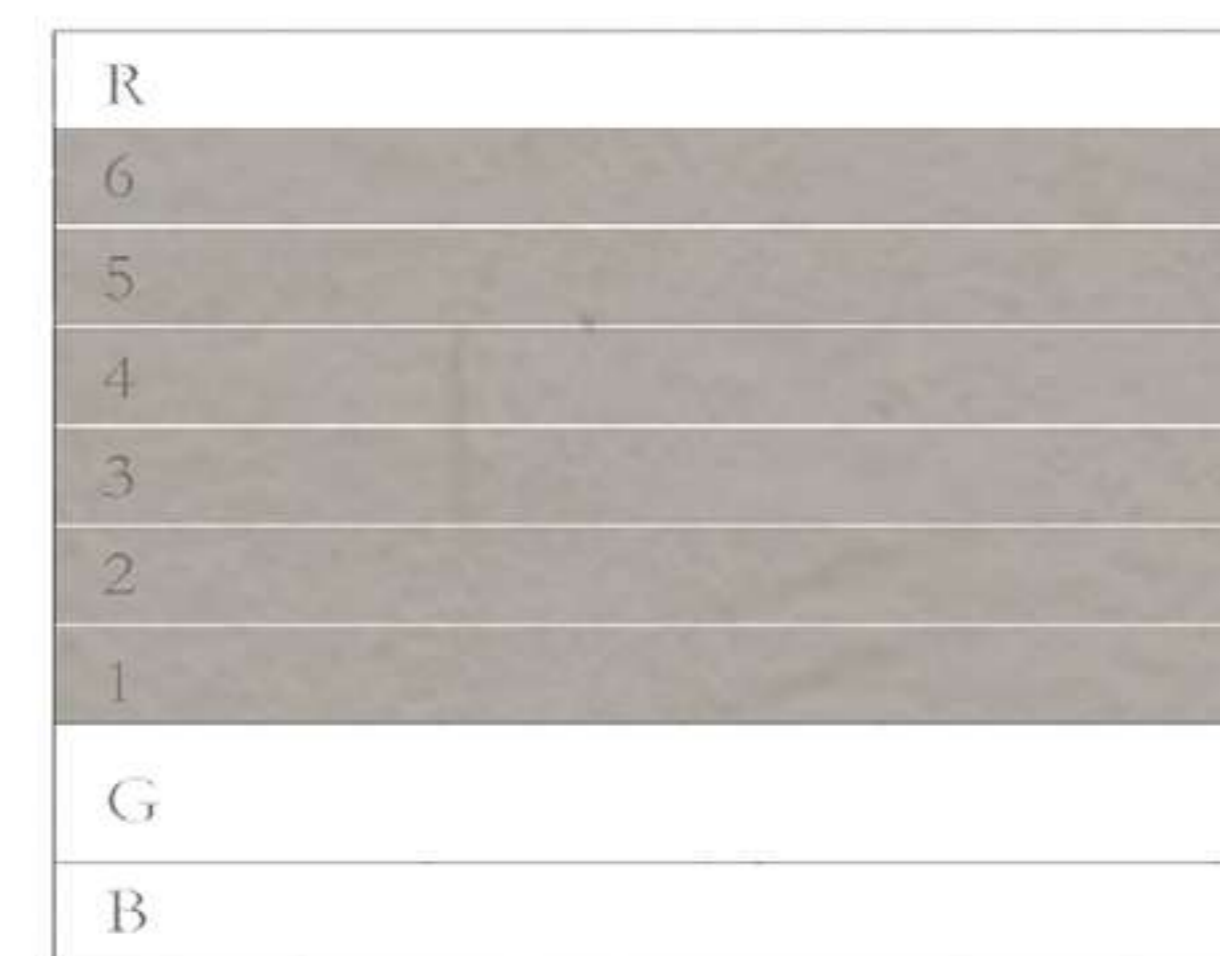

Disclaimer: All dimensions are in imperials and metric, and measured from excluding construction tolerances. 2. All materials, dimensions, and drawings are approximate only. 3. Information is subject to change without notice, At developer's absolute discretion. 04. Actual area may vary from the stated area. 5. drawings not to scale. 6. All images used are for illustrative purposes only and do not represent the actual size, features, specifications, fitting, and furnishings. 7. the developer reserves the right to make revisions / alterations, at its absolute discretion, without any liability whatsoever

# OCEAN VIEWS

RASHID YACHTS & MARINA

## BUILDING B

### 2 BEDROOM TYPE-B2

	LEVEL 01-06	UNITS B-06
SUITE AREA	1104.81 SQ.FT.	102.64 SQ.M.
BALCONY AREA	164.69 SQ.FT.	15.30 SQ.M.
TOTAL AREA	1269.50 SQ.FT.	117.94 SQ.M.



KEY PLAN  
LEVEL 01-06

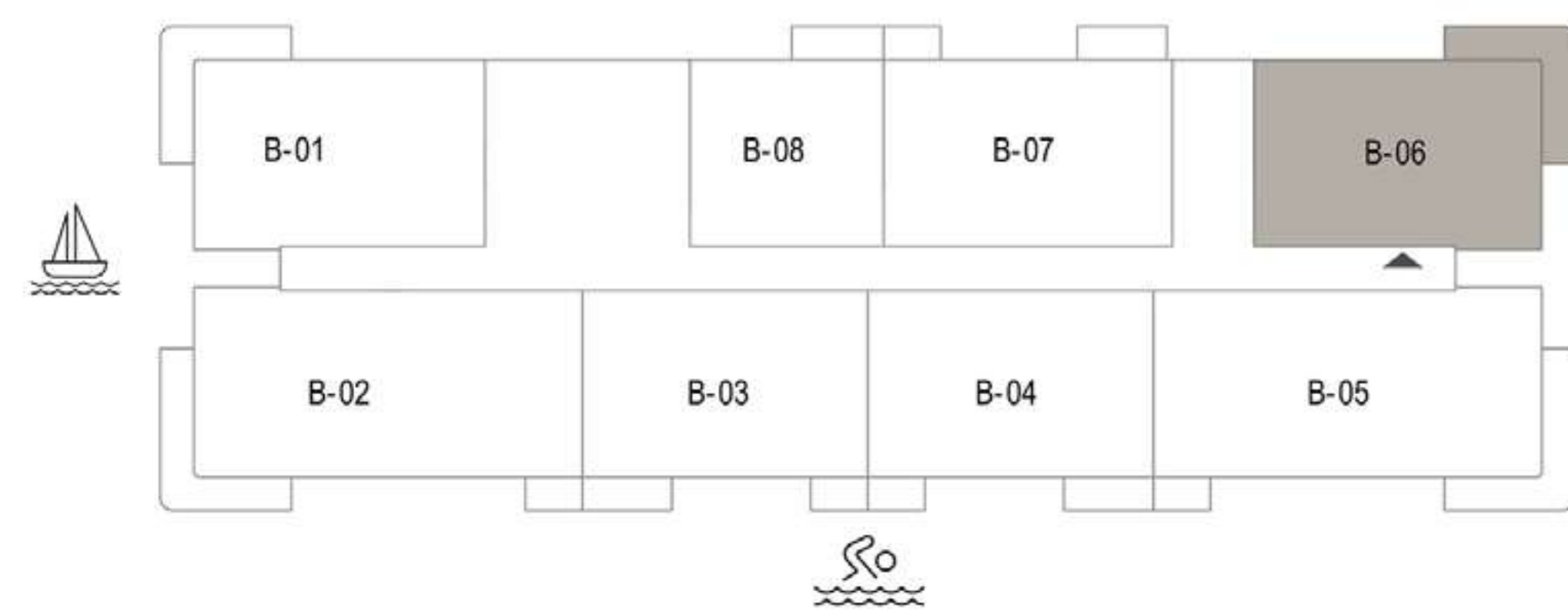

KEY SECTION

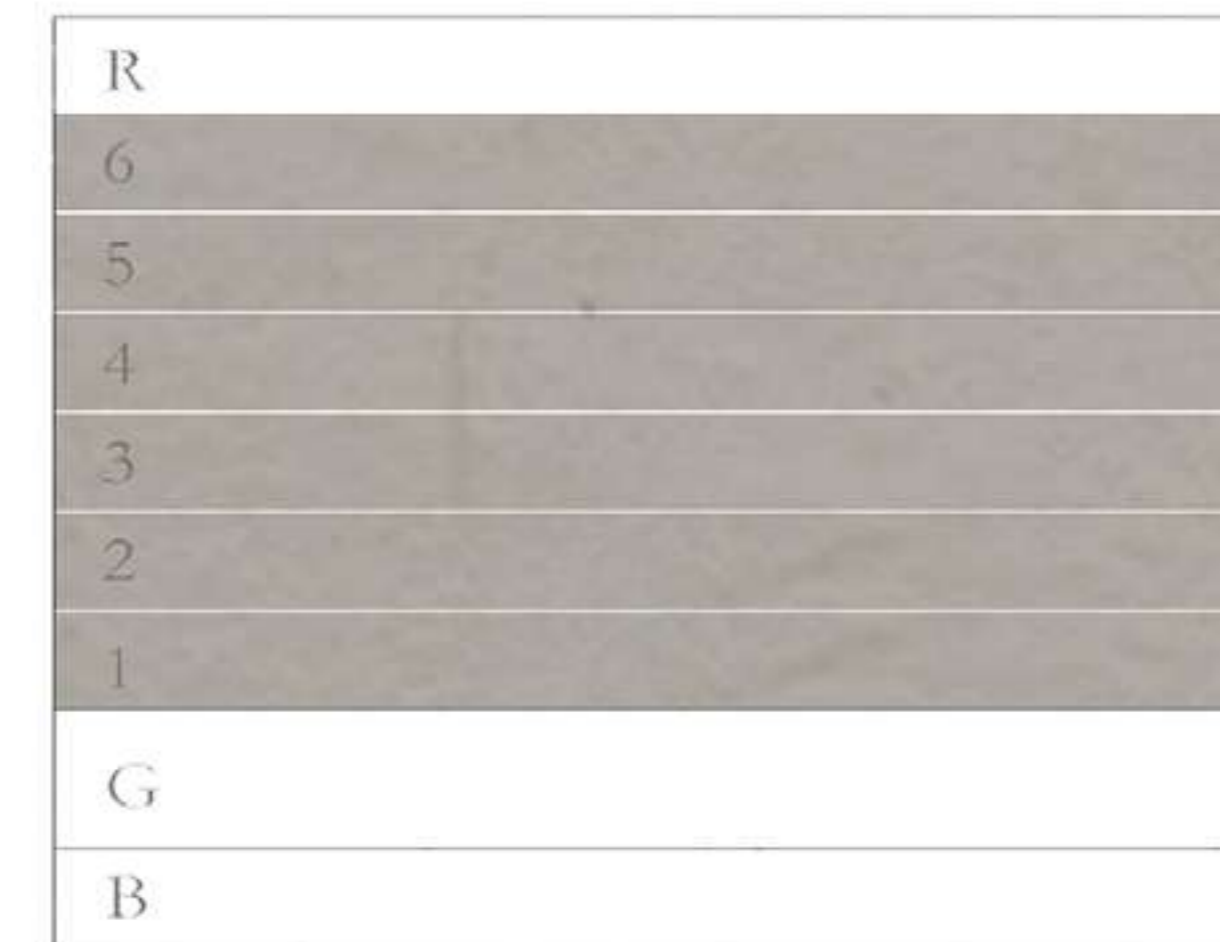

Disclaimer: All dimensions are in imperials and metric, and measured from excluding construction tolerances. 2. All materials, dimensions, and drawings are approximate only. 3. Information is subject to change without notice, At developer's absolute discretion. 04. Actual area may vary from the stated area. 5. drawings not to scale. 6. All images used are for illustrative purposes only and do not represent the actual size, features, specifications, fitting, and furnishings. 7. the developer reserves the right to make revisions / alterations, at its absolute discretion, without any liability whatsoever

# OCEAN VIEWS

RASHID YACHTS & MARINA

## BUILDING B

### 2 BEDROOM TYPE-A2

	LEVEL 01-06	UNITS B-07
SUITE AREA	1115.46 SQ.FT.	103.63 SQ.M.
BALCONY AREA	102.58 SQ.FT.	9.53 SQ.M.
TOTAL AREA	1218.04 SQ.FT.	113.16 SQ.M.



KEY PLAN  
LEVEL 01-06

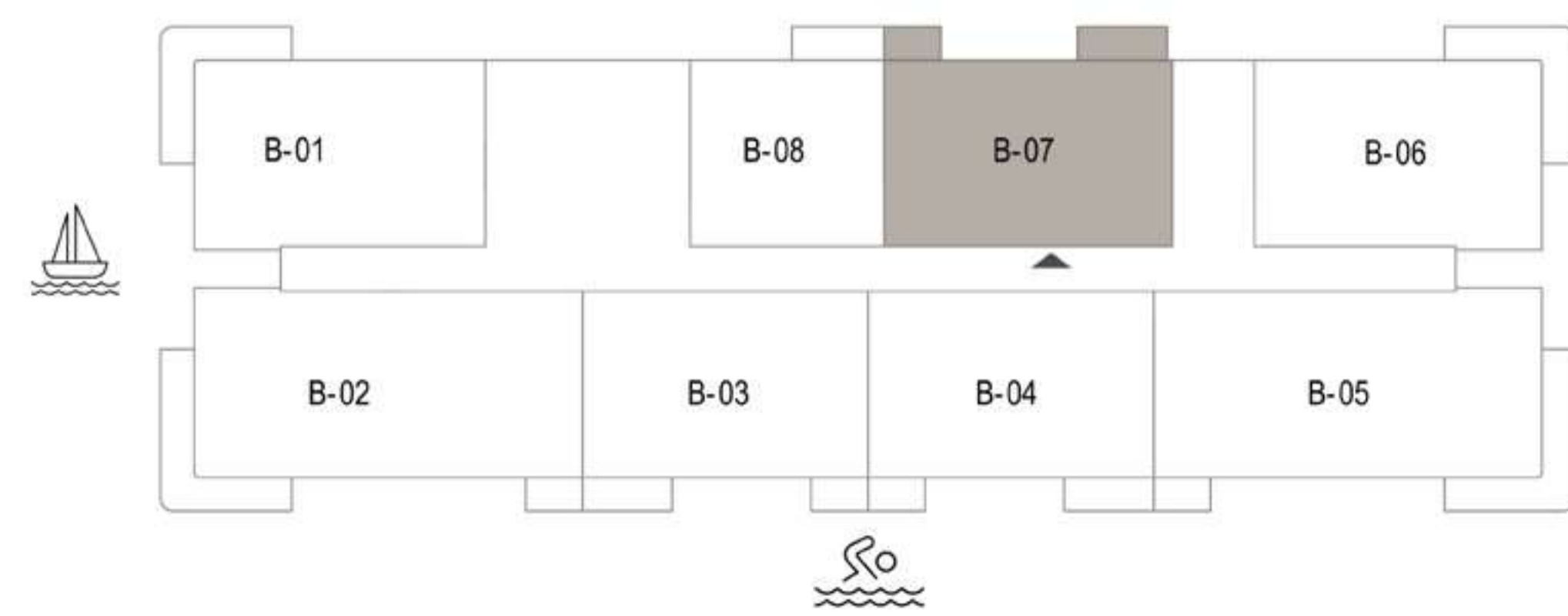

KEY SECTION

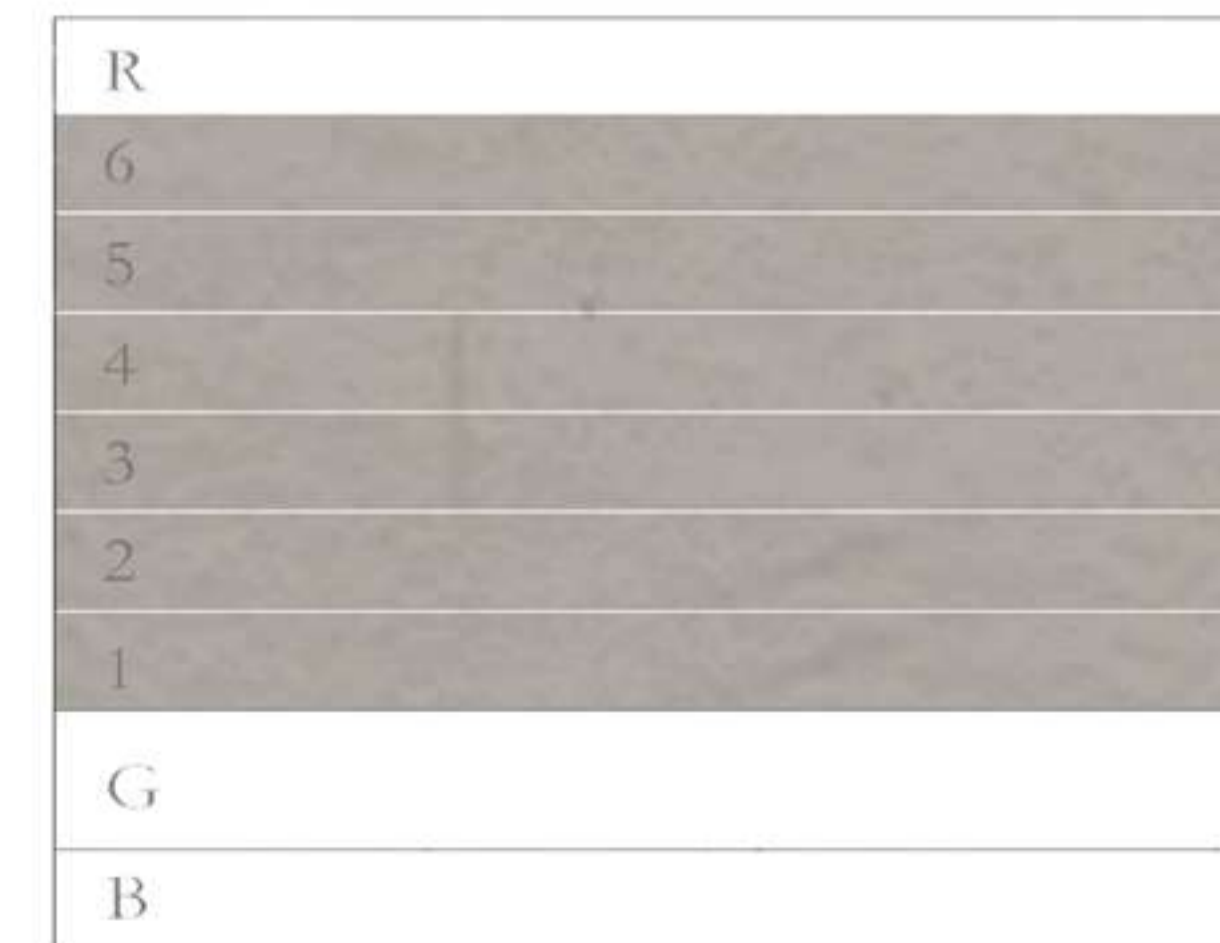

Disclaimer: All dimensions are in imperials and metric, and measured from excluding construction tolerances. 2. All materials, dimensions, and drawings are approximate only. 3. Information is subject to change without notice, At developer's absolute discretion. 04. Actual area may vary from the stated area. 5. drawings not to scale. 6. All images used are for illustrative purposes only and do not represent the actual size, features, specifications, fitting, and furnishings. 7. the developer reserves the right to make revisions / alterations, at its absolute discretion, without any liability whatsoever

# OCEAN VIEWS

RASHID YACHTS & MARINA

## BUILDING B

### 3 BEDROOM TYPE-A2

	LEVEL 01-06	UNITS B-02
SUITE AREA	1504.04 SQ.FT.	139.73 SQ.M.
BALCONY AREA	222.60 SQ.FT.	20.68 SQ.M.
TOTAL AREA	1726.64 SQ.FT.	160.41 SQ.M.



KEY PLAN  
LEVEL 01-06

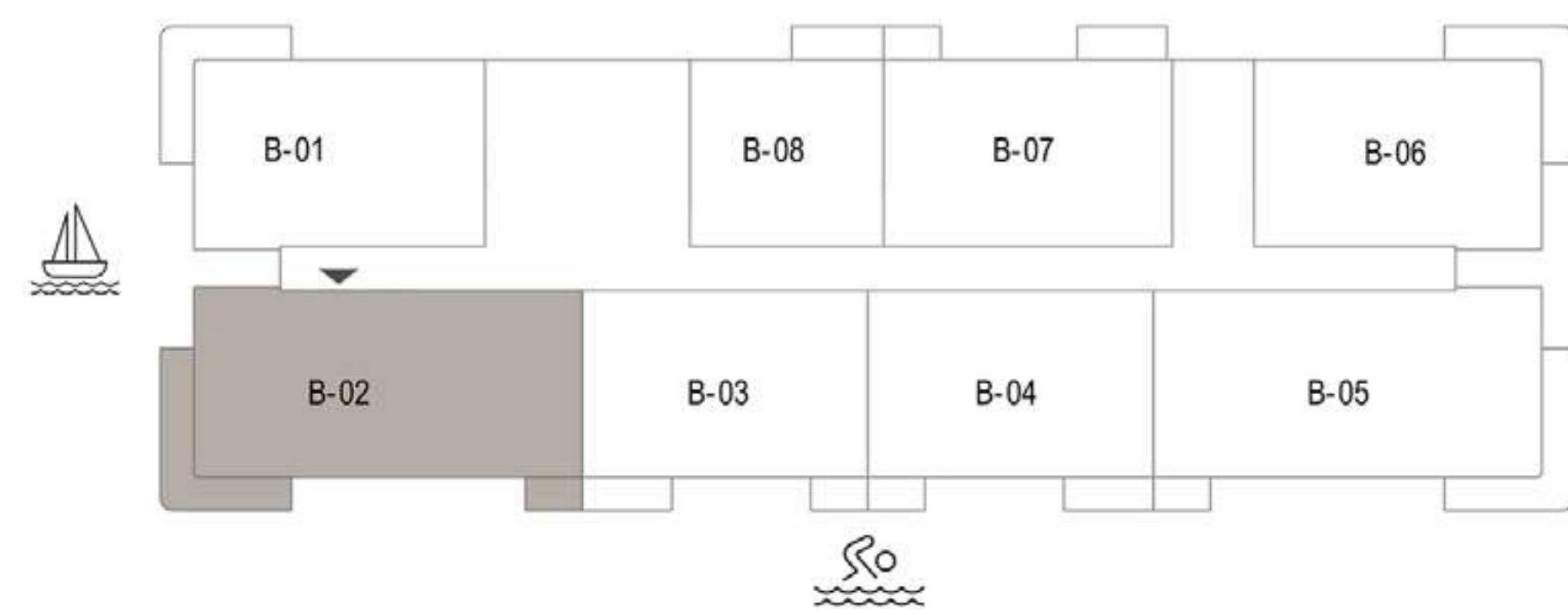

KEY SECTION

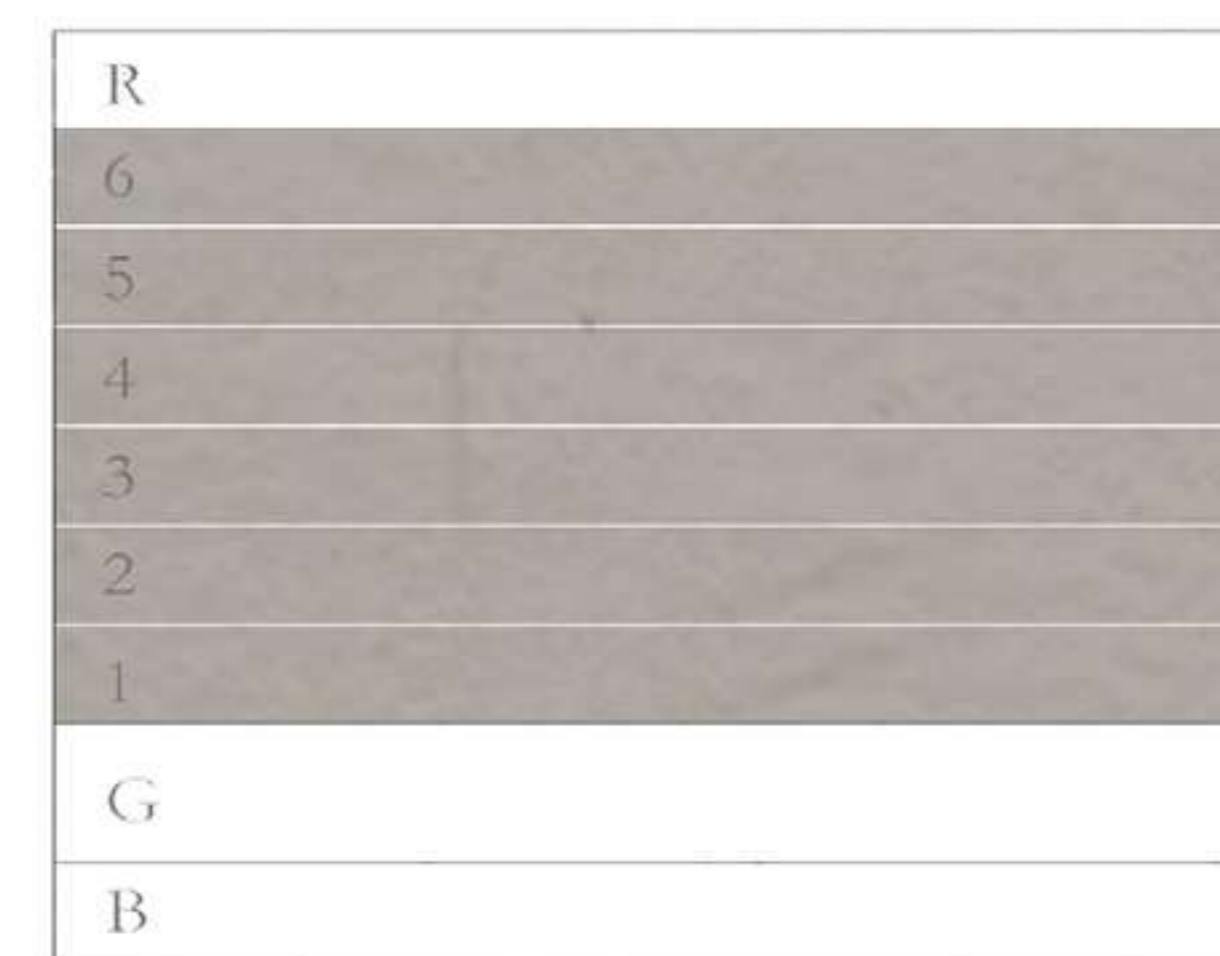

Disclaimer: All dimensions are in imperials and metric, and measured from excluding construction tolerances. 2. All materials, dimensions, and drawings are approximate only. 3. Information is subject to change without notice, At developer's absolute discretion. 04. Actual area may vary from the stated area. 5. drawings not to scale. 6. All images used are for illustrative purposes only and do not represent the actual size, features, specifications, fitting, and furnishings. 7. the developer reserves the right to make revisions / alterations, at its absolute discretion, without any liability whatsoever.

# OCEAN VIEWS

RASHID YACHTS & MARINA

## BUILDING B

### 3 BEDROOM TYPE-A1

	LEVEL 01-06	UNITS B-05
SUITE AREA	1503.93 SQ.FT.	139.72 SQ.M.
BALCONY AREA	222.60 SQ.FT.	20.68 SQ.M.
TOTAL AREA	1726.53 SQ.FT.	160.40 SQ.M.



KEY PLAN  
LEVEL 01-06

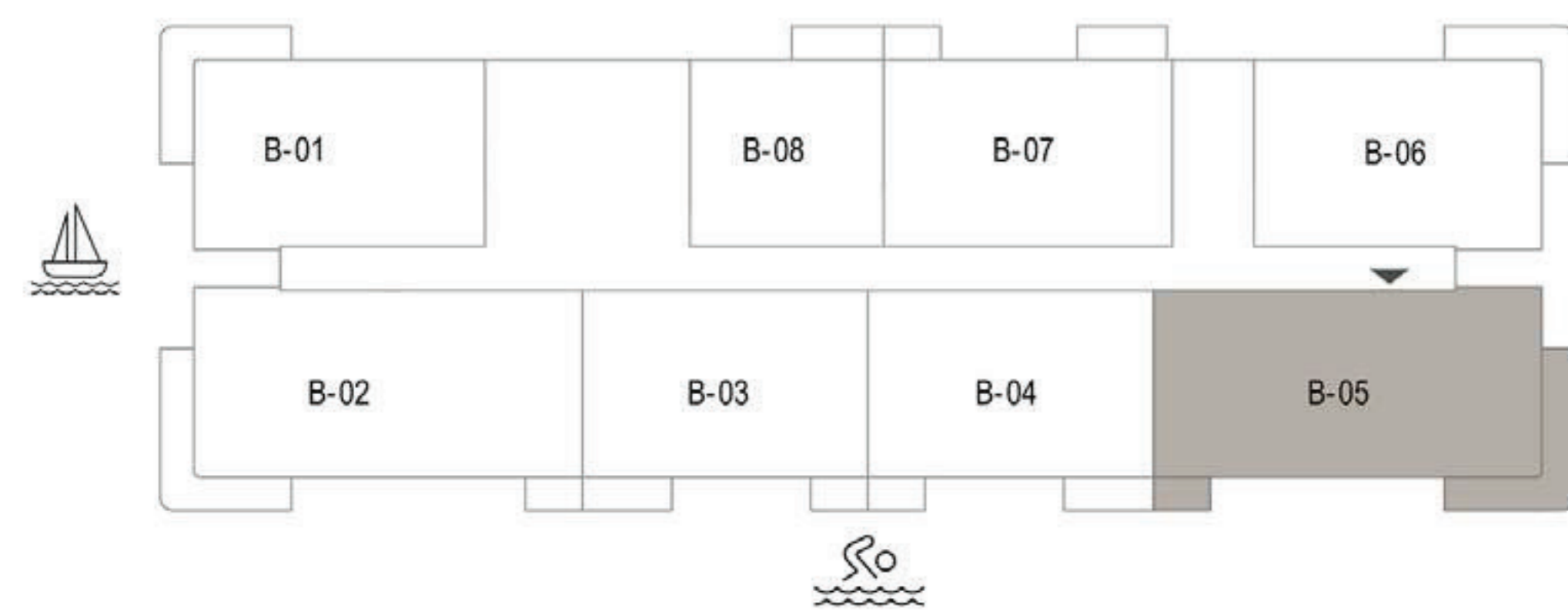

KEY SECTION

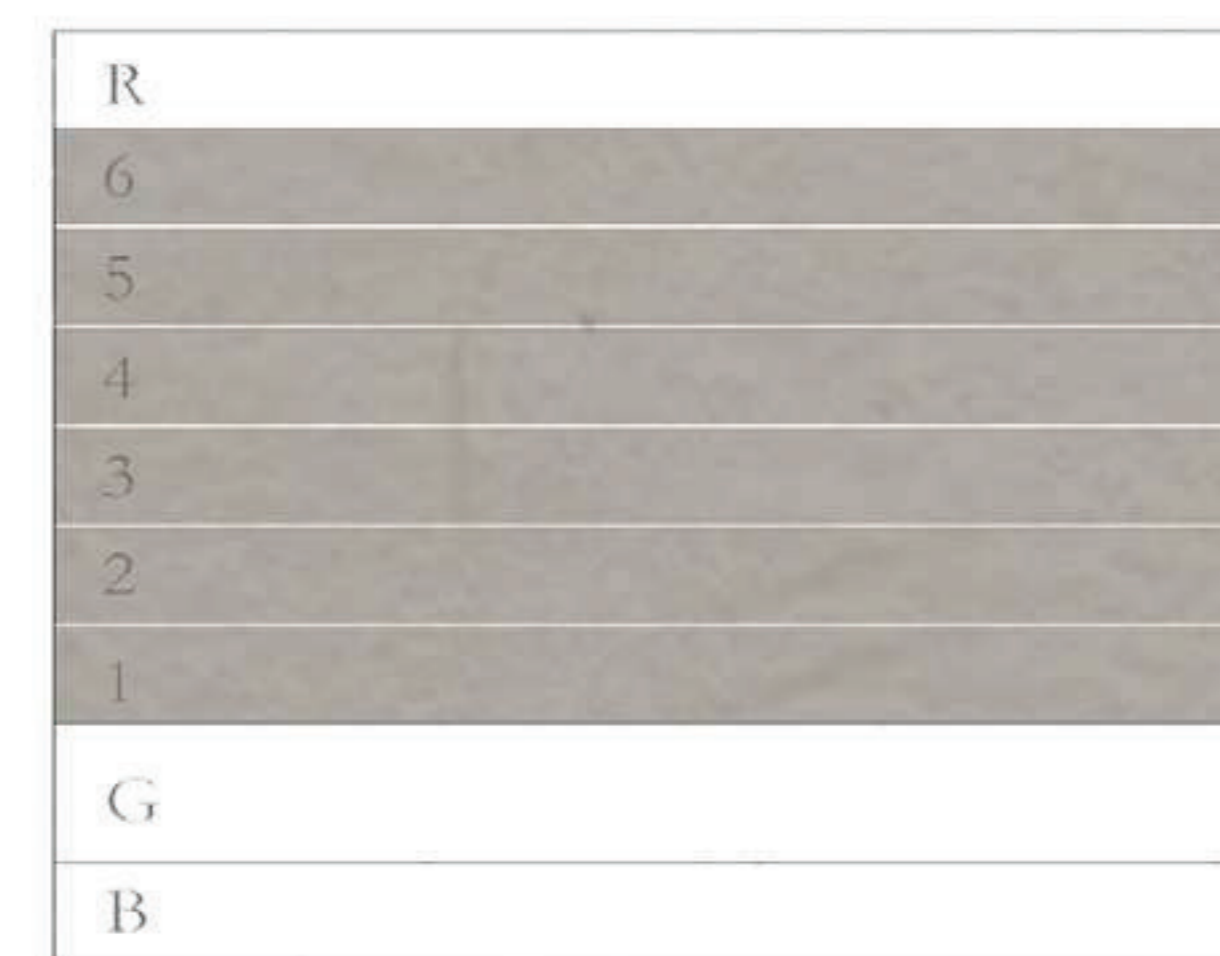

Disclaimer: All dimensions are in imperials and metric, and measured from excluding construction tolerances. 2. All materials, dimensions, and drawings are approximate only. 3. Information is subject to change without notice, At developer's absolute discretion. 04. Actual area may vary from the stated area. 5. drawings not to scale. 6. All images used are for illustrative purposes only and do not represent the actual size, features, specifications, fitting, and furnishings. 7. the developer reserves the right to make revisions / alterations, at its absolute discretion, without any liability whatsoever.

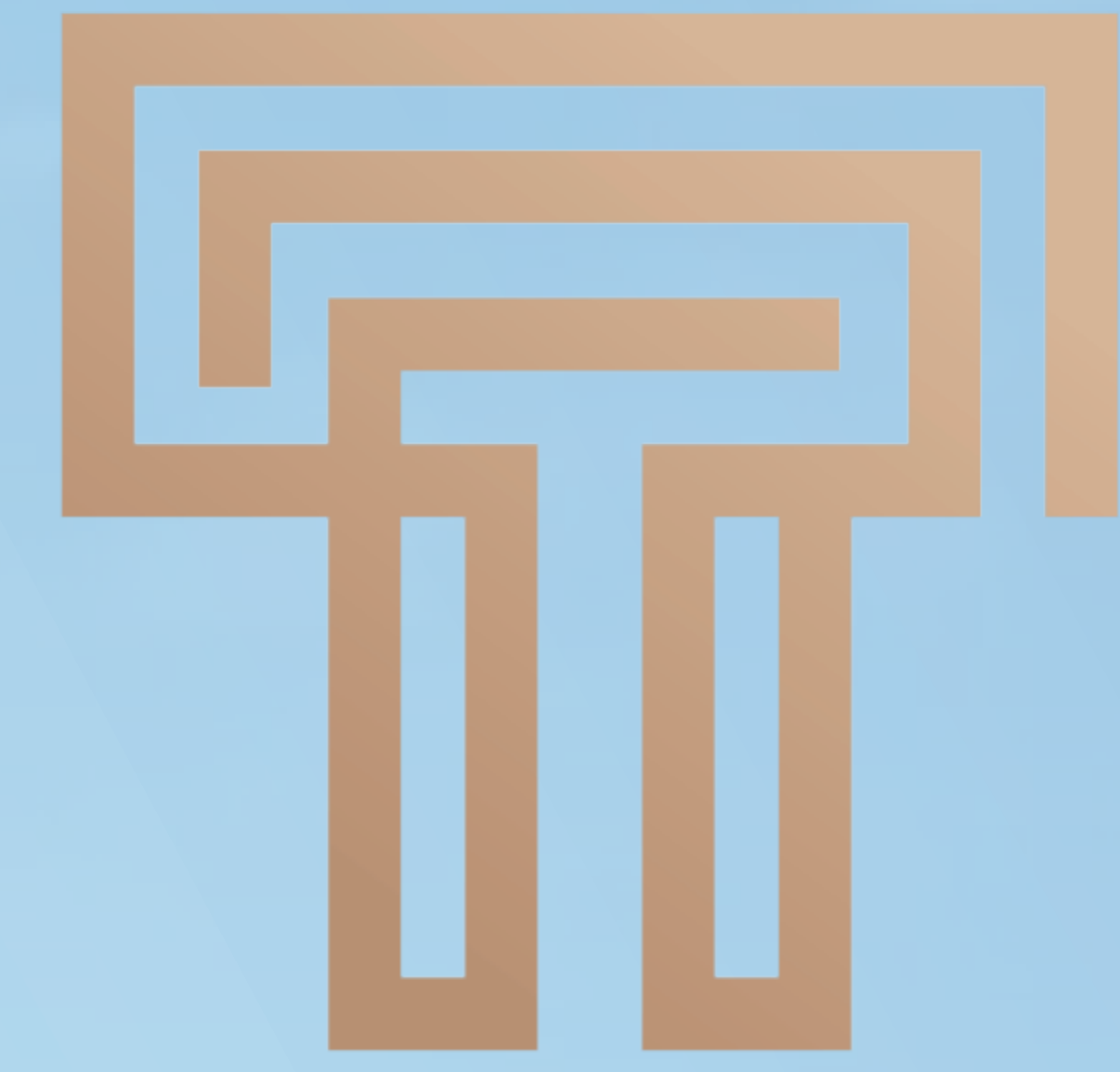

**TANAMI**  
P R O P E R T I E S

*Contact Us*

+971 4 248 3400, +971 55 162 3236

info@tanamiproperties.ae

*For More Info...*

[www.tanamiproperties.com/Projects/Emaar-Ocean-Views-Mina-Rashid](http://www.tanamiproperties.com/Projects/Emaar-Ocean-Views-Mina-Rashid)



3405, Marina Plaza, Al Marsa Street, Dubai Marina, UAE