





ELLINGTON
PROPERTIES

The Crestmark

FLOOR PLANS

ELLINGTON

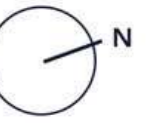
The Crestmark



4TH FLOOR PLAN

-  STUDIO
-  1 BEDROOM
-  2 BEDROOM
-  3 BEDROOM

The Crestmark

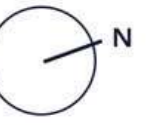

5TH, 8TH & 10TH FLOOR TYPICAL PLAN

-  STUDIO
-  1 BEDROOM
-  2 BEDROOM
-  3 BEDROOM

The Crestmark

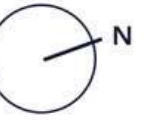

6TH, 9TH & 11TH FLOOR TYPICAL PLAN

-  STUDIO
-  1 BEDROOM
-  2 BEDROOM
-  3 BEDROOM



The Crestmark

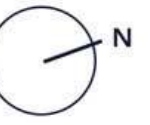

7TH FLOOR PLAN

-  STUDIO
-  1 BEDROOM
-  2 BEDROOM
-  3 BEDROOM

The Crestmark

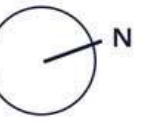

12TH & 13TH FLOOR
TYPICAL PLAN

-  STUDIO
-  1 BEDROOM
-  2 BEDROOM
-  3 BEDROOM

The Crestmark

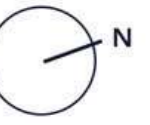

14TH FLOOR PLAN

-  STUDIO
-  1 BEDROOM
-  2 BEDROOM
-  3 BEDROOM

FLOATING VILLAS

DUBAI WATER CANAL BOARDWALK

DUBAI WATER CANAL

FLOATING VILLAS

The Crestmark

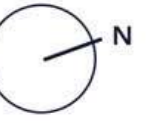

15TH & 18TH FLOOR
TYPICAL PLAN

-  STUDIO
-  1 BEDROOM
-  2 BEDROOM
-  3 BEDROOM

FLOATING VILLAS

DUBAI WATER CANAL BOARDWALK

DUBAI WATER CANAL

FLOATING VILLAS

The Crestmark

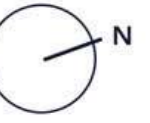

16TH & 17TH FLOOR TYPICAL PLAN

-  STUDIO
-  1 BEDROOM
-  2 BEDROOM
-  3 BEDROOM

FLOATING VILLAS

DUBAI WATER CANAL BOARDWALK

DUBAI WATER CANAL

FLOATING VILLAS



The Crestmark

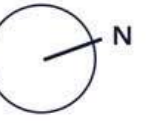

19TH FLOOR PLAN

-  STUDIO
-  1 BEDROOM
-  2 BEDROOM
-  3 BEDROOM

The Crestmark

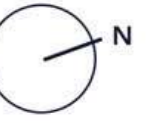

20TH FLOOR PLAN

-  STUDIO
-  1 BEDROOM
-  2 BEDROOM
-  3 BEDROOM

Studio

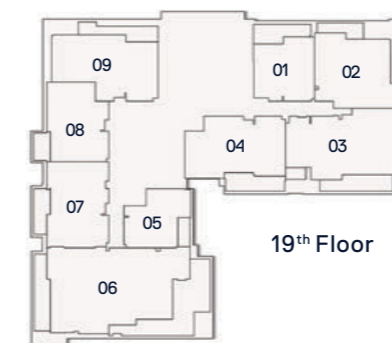
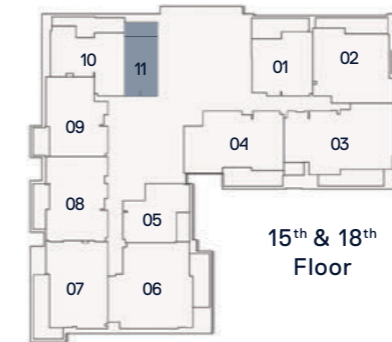
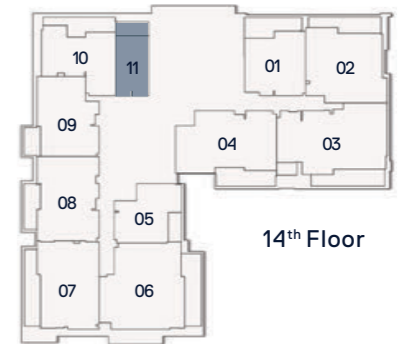
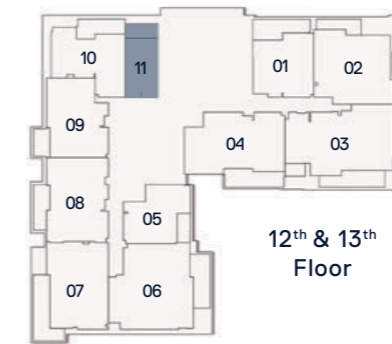
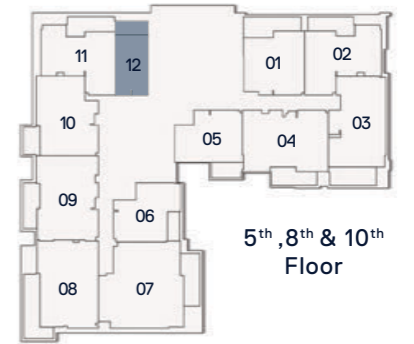
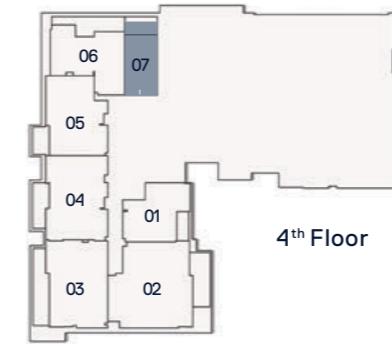
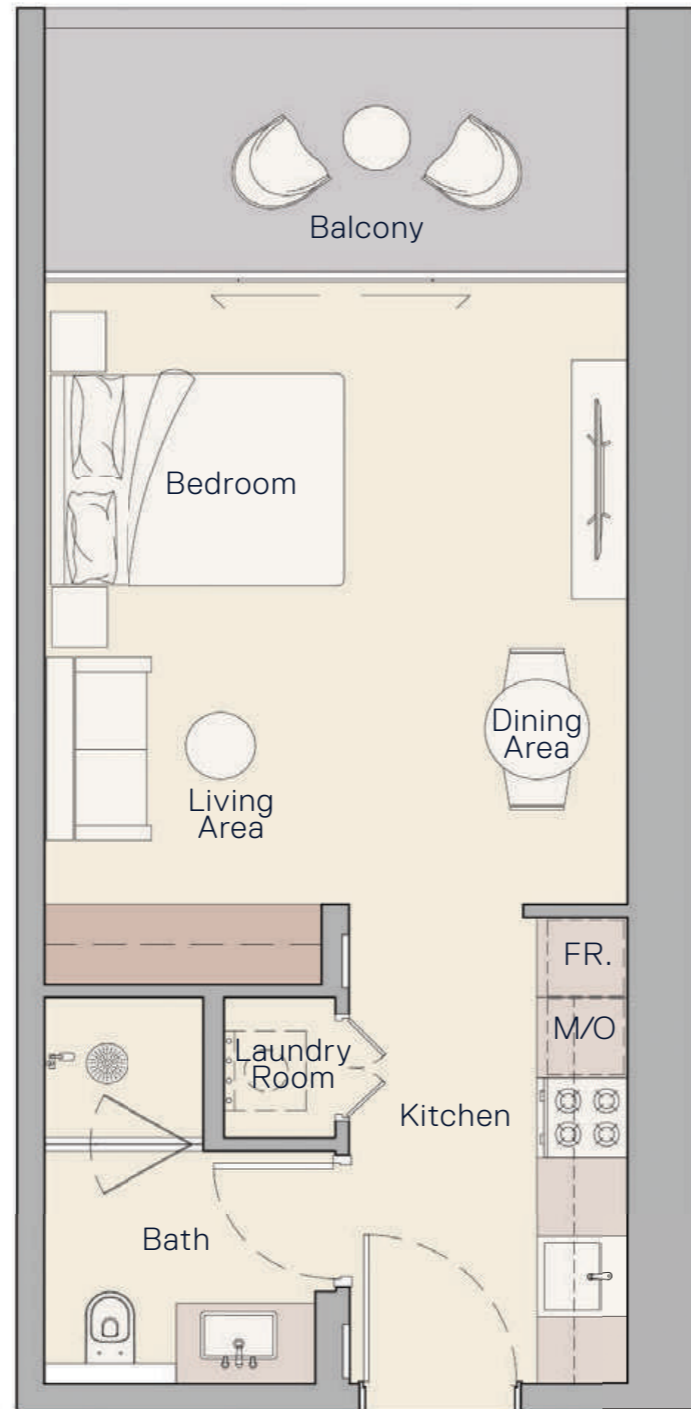

Internal Living Area

Outdoor Living Area

Total Living Area

409.67 Sq. Ft

96.12 Sq. Ft

505.80 Sq. Ft

1 Bedroom TYPE A



Internal Living Area
671.88 Sq. Ft

Outdoor Living Area
75.24 Sq. Ft

Total Living Area
747.12 Sq. Ft

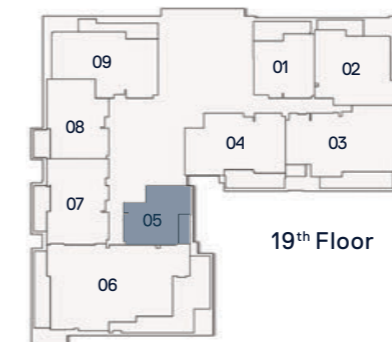
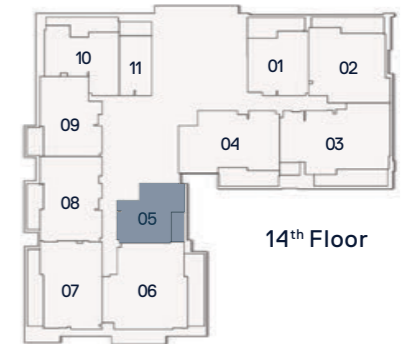
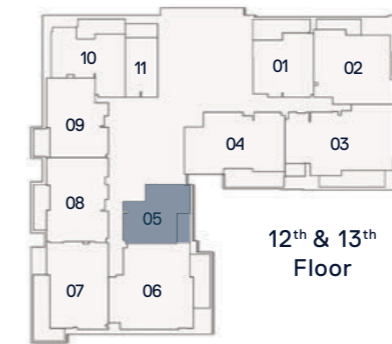
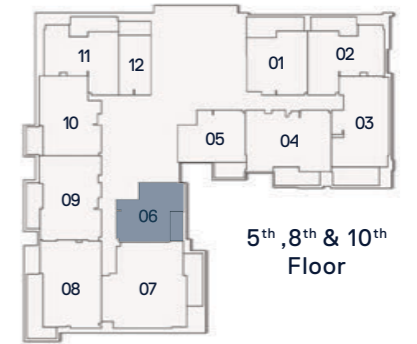
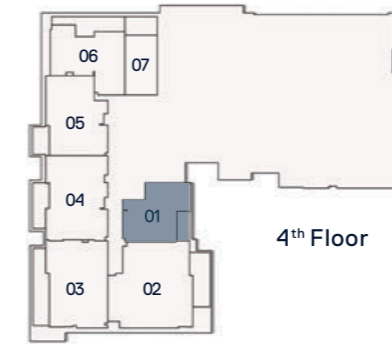

1 Bedroom TYPE B



Internal Living Area

830.54 Sq. Ft

Outdoor Living Area

174.70 Sq. Ft

Total Living Area

1005.24 Sq. Ft

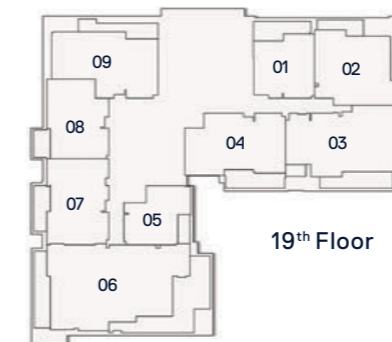
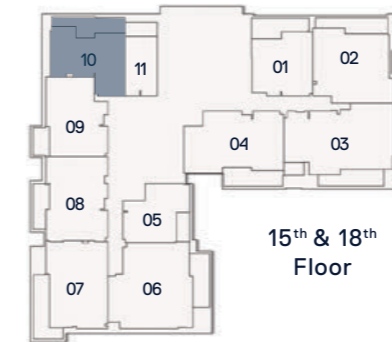
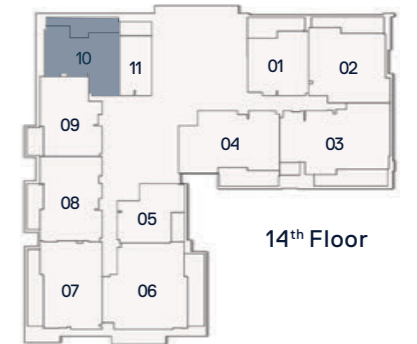
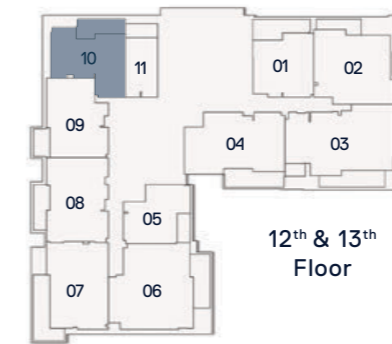
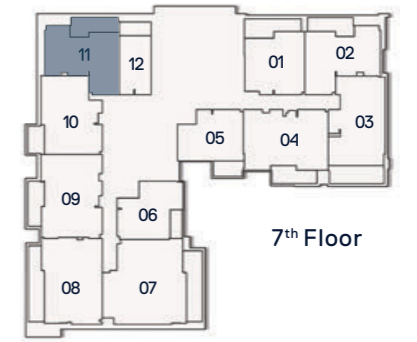
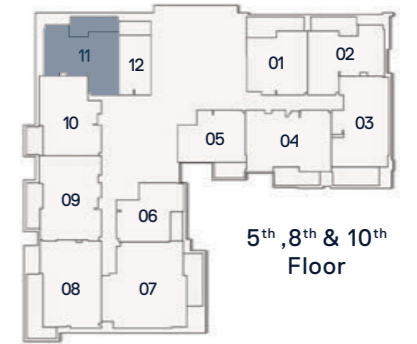
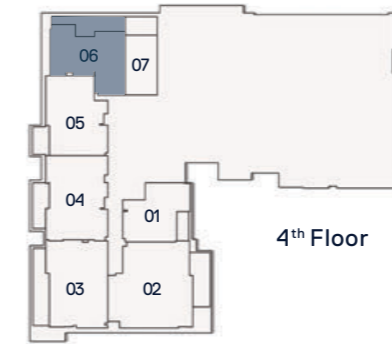

1 Bedroom TYPE C

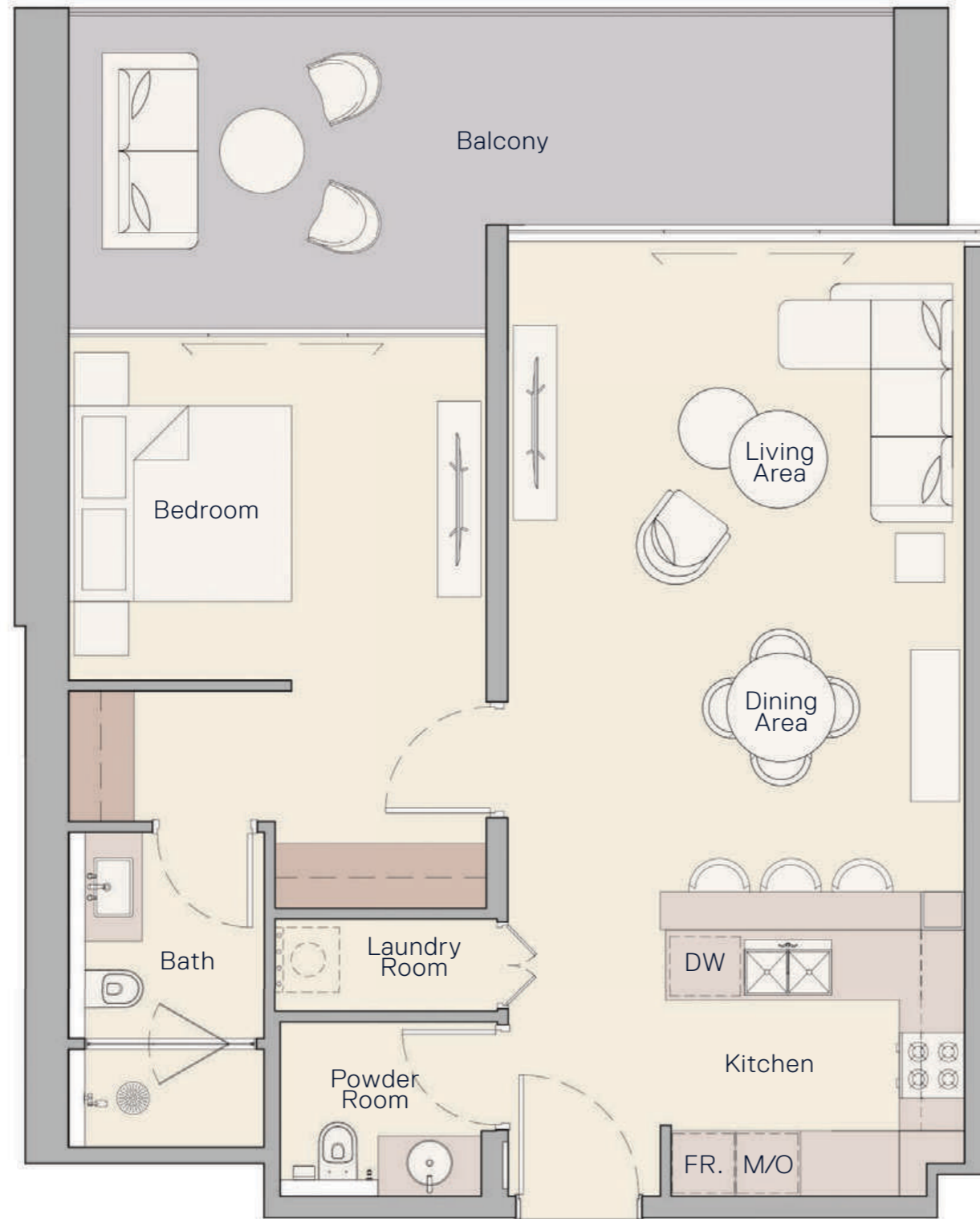

Internal Living Area
772.96 Sq. Ft

Outdoor Living Area
217.43 Sq. Ft

Total Living Area
990.39 Sq. Ft

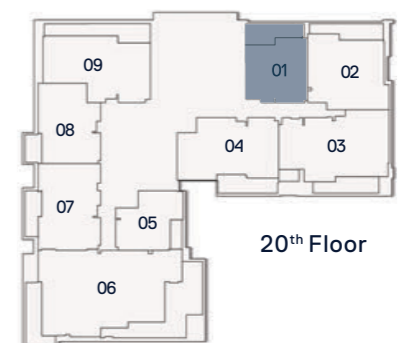
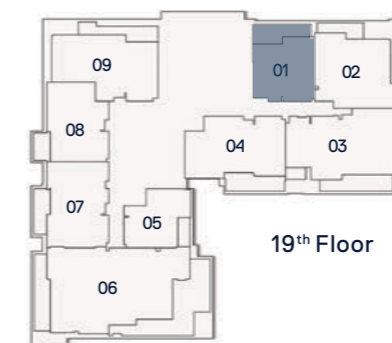
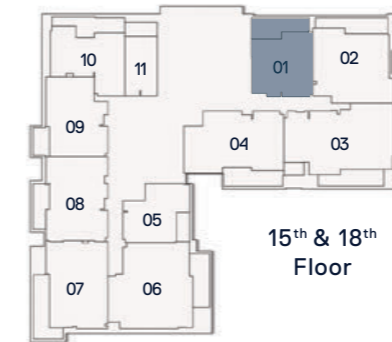
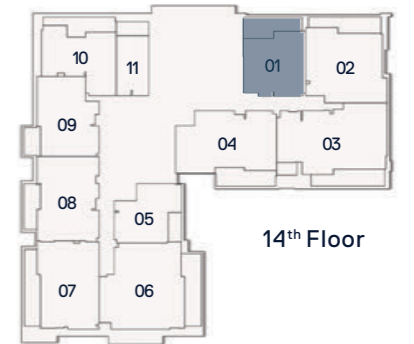
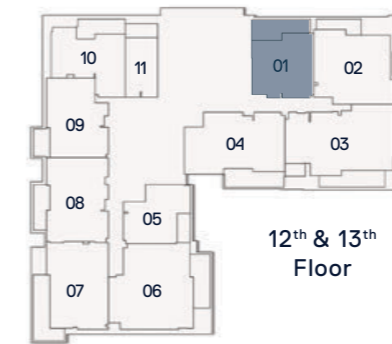
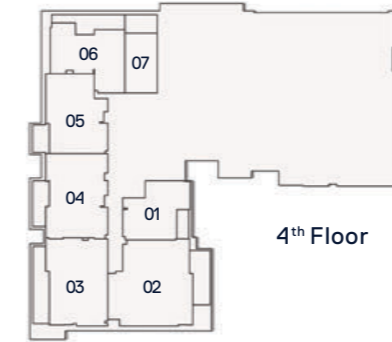

1 Bedroom TYPE D

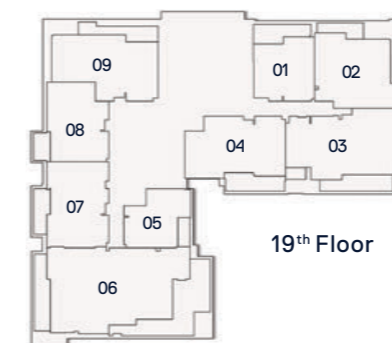
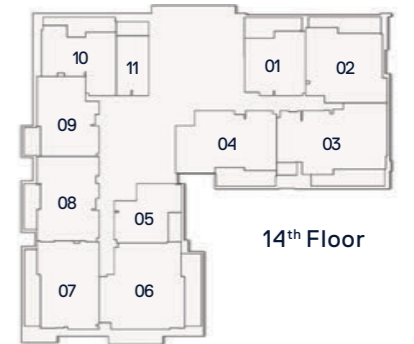
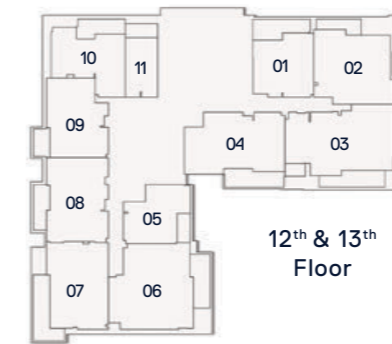
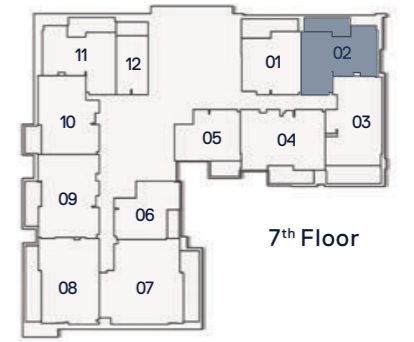
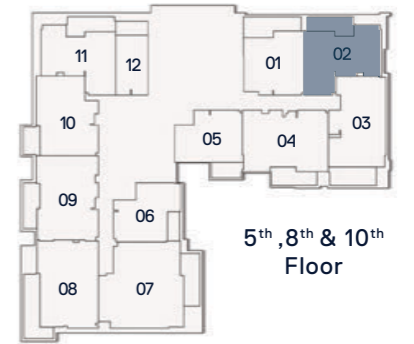
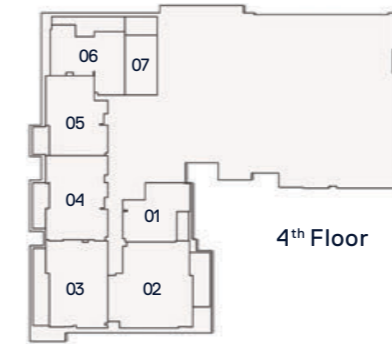

Internal Living Area

Outdoor Living Area

Total Living Area

866.39 Sq. Ft

160.27 Sq. Ft

1026.66 Sq. Ft

1 Bedroom TYPE E

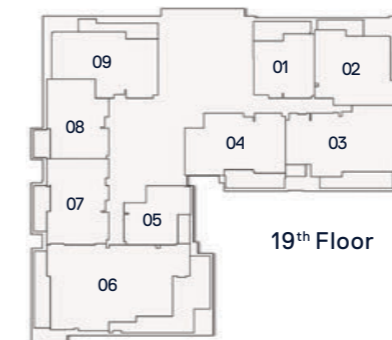
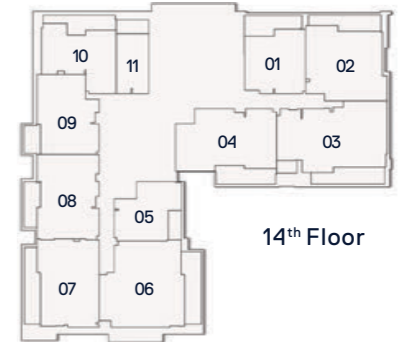
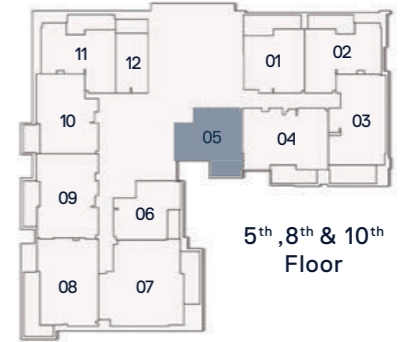
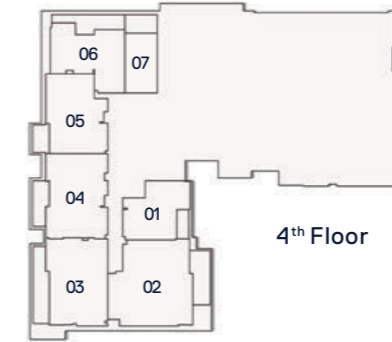

Internal Living Area
680.60 Sq. Ft

Outdoor Living Area
100.32 Sq. Ft

Total Living Area
780.92 Sq. Ft

2 Bedroom TYPE A



Internal Living Area
1095.66 Sq. Ft

Outdoor Living Area
253.27 Sq. Ft

Total Living Area
1348.93 Sq. Ft

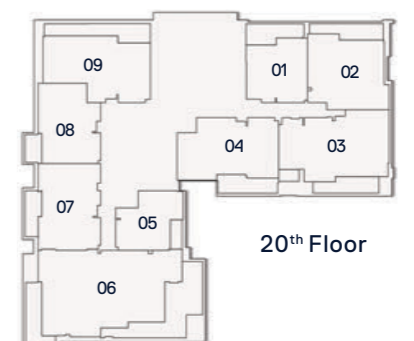
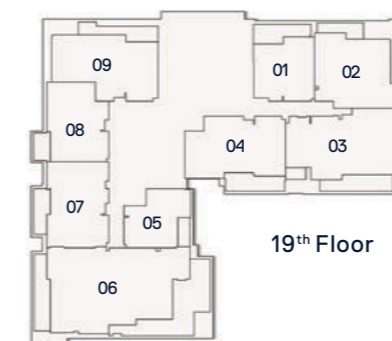
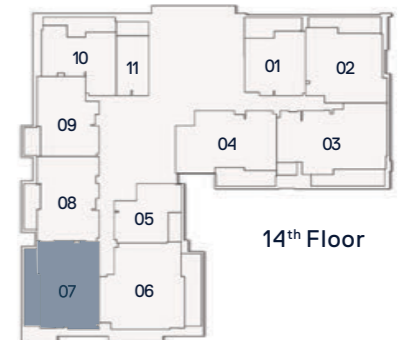
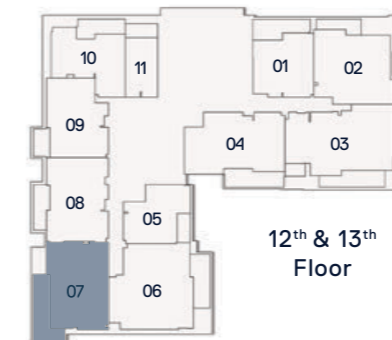
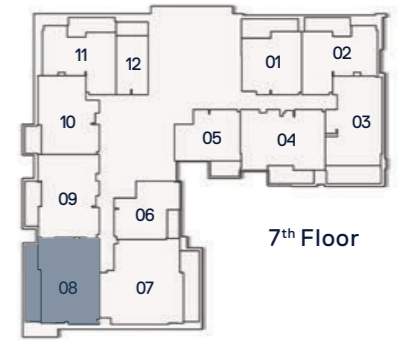
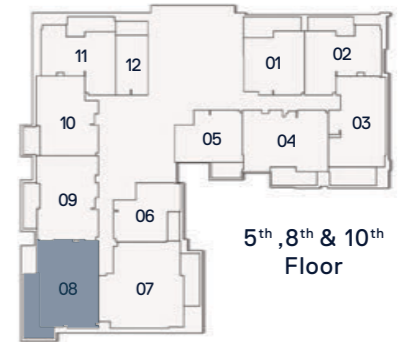
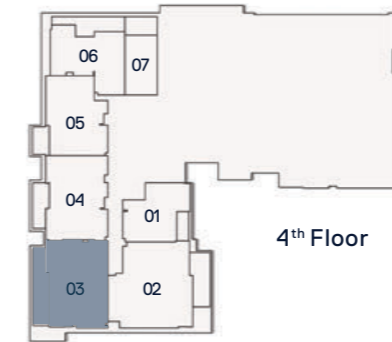

2 Bedroom TYPE B



Internal Living Area
1076.61 Sq. Ft

Outdoor Living Area
147.57 Sq. Ft

Total Living Area
1224.18 Sq. Ft

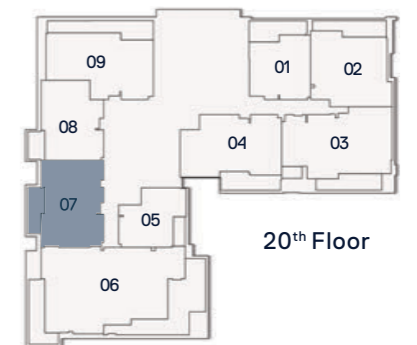
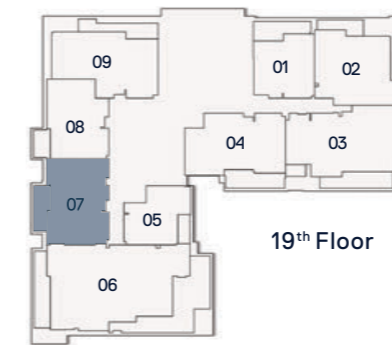
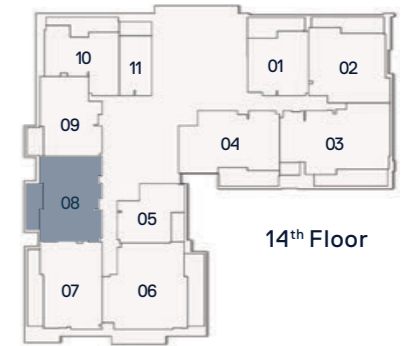
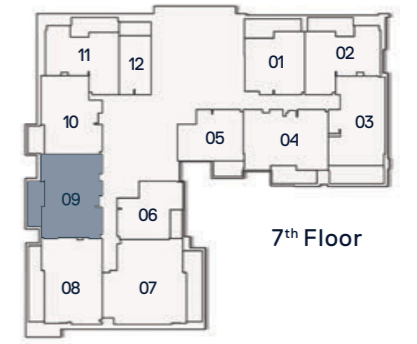
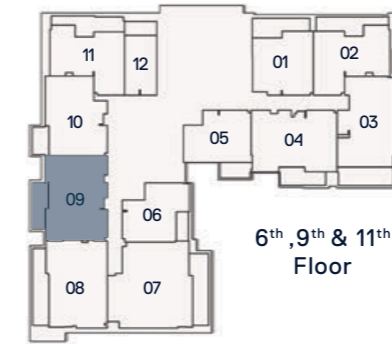
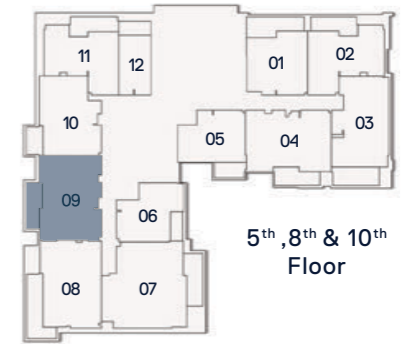
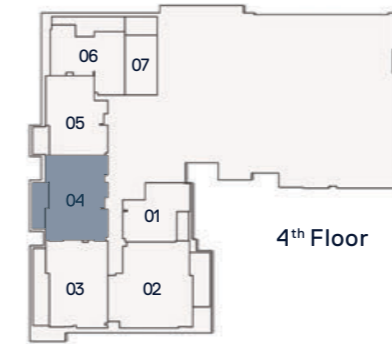

2 Bedroom TYPE C

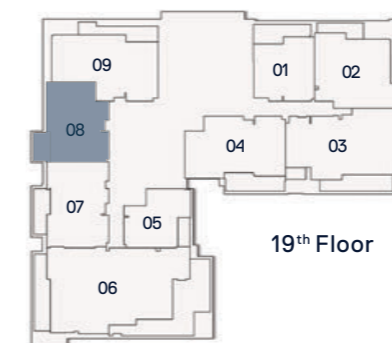
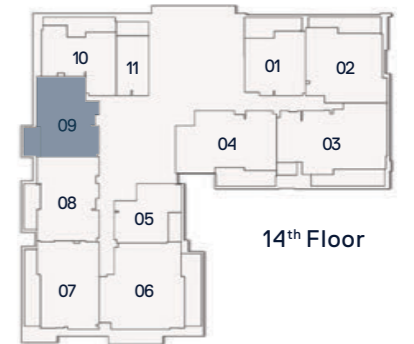
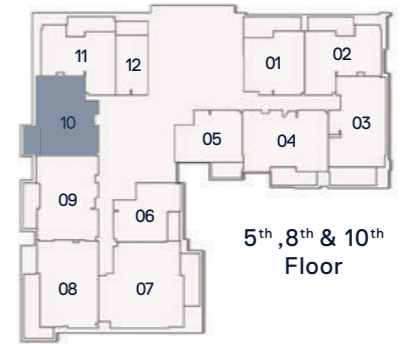

Internal Living Area
947.12 Sq. Ft

Outdoor Living Area
99.35 Sq. Ft

Total Living Area
1046.47 Sq. Ft

2 Bedroom TYPE D

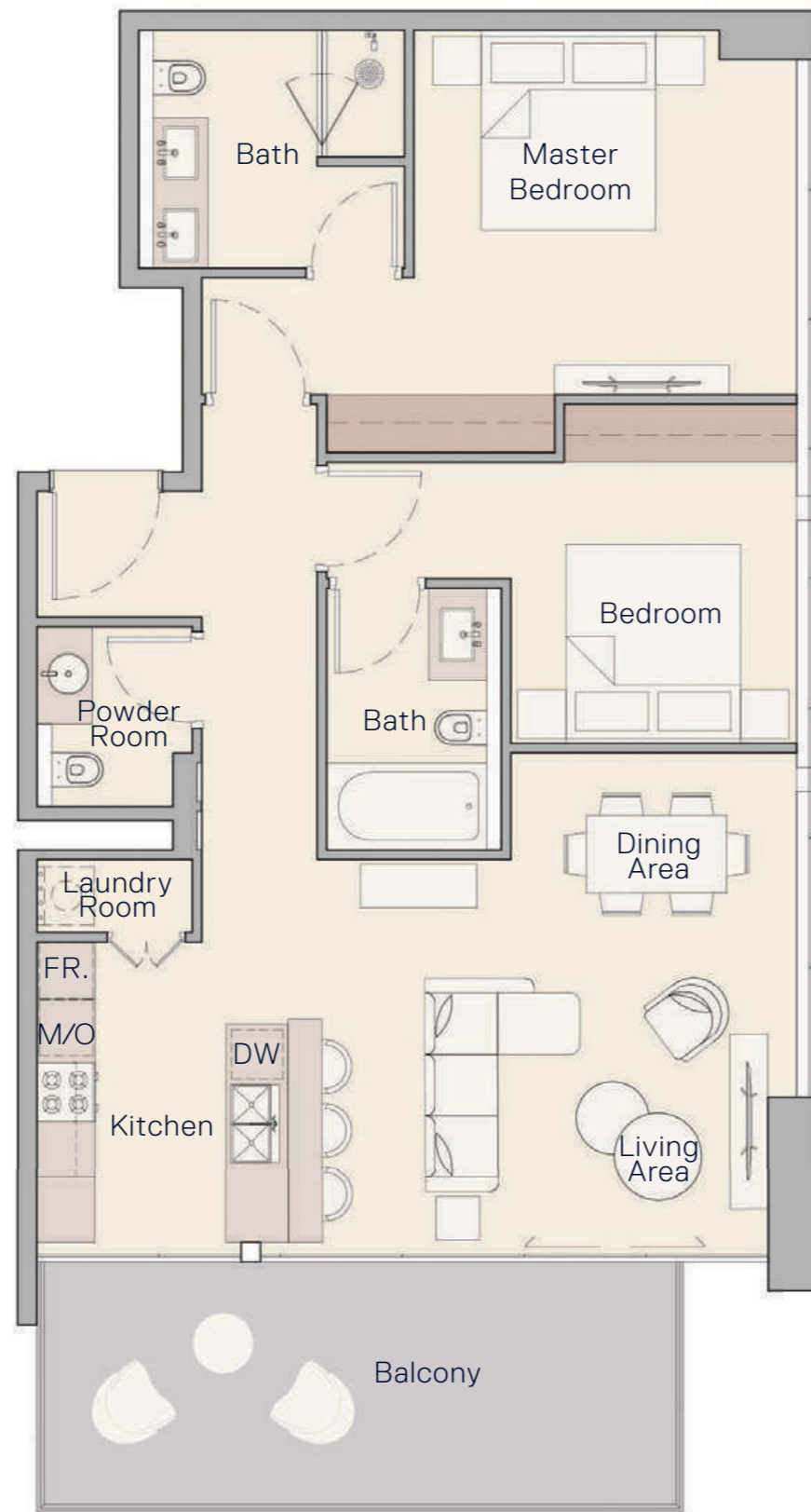

Internal Living Area
1026.55 Sq. Ft

Outdoor Living Area
183.42 Sq. Ft

Total Living Area
1209.97 Sq. Ft

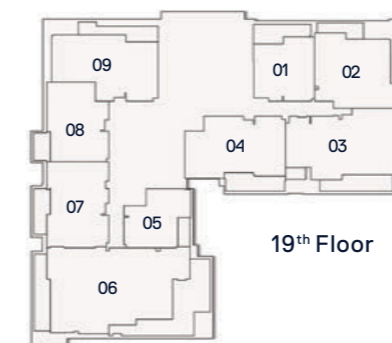
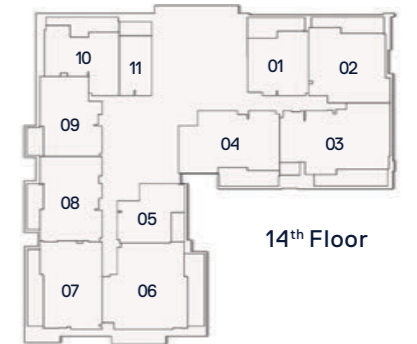
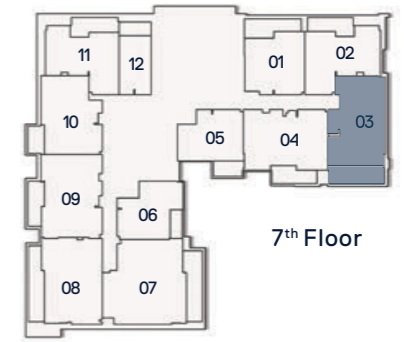
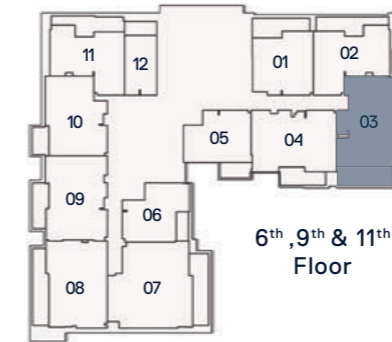
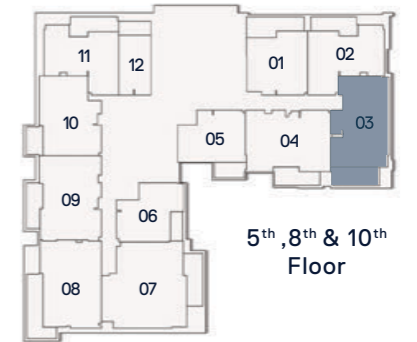
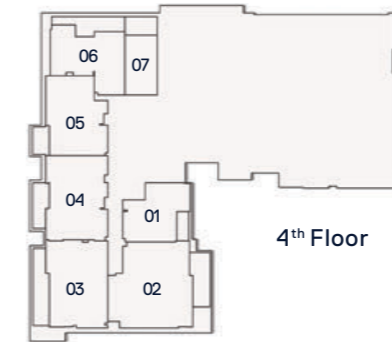

2 Bedroom TYPE E

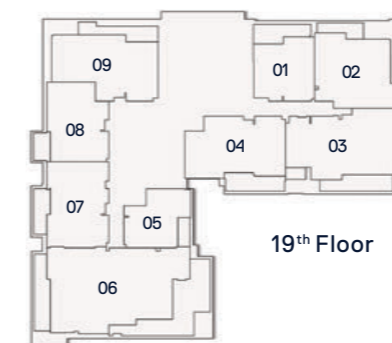
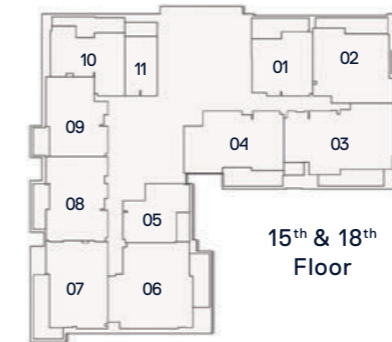
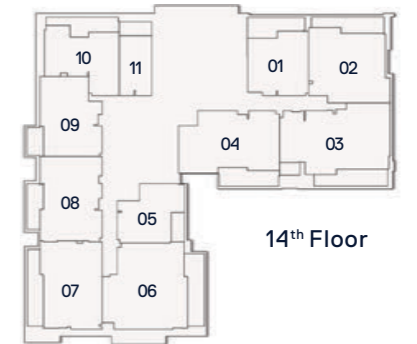
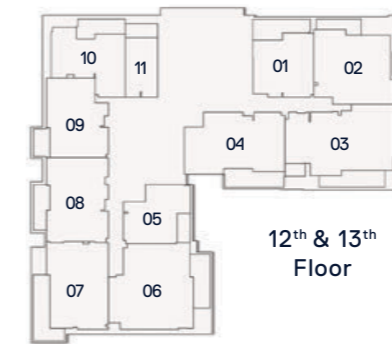
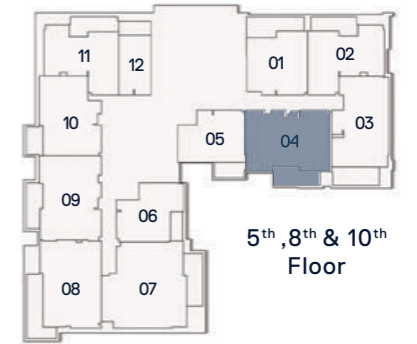
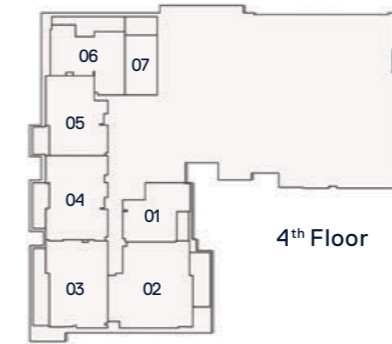

Internal Living Area
1079.62 Sq. Ft

Outdoor Living Area
157.69 Sq. Ft

Total Living Area
1237.31 Sq. Ft

2 Bedroom TYPE F

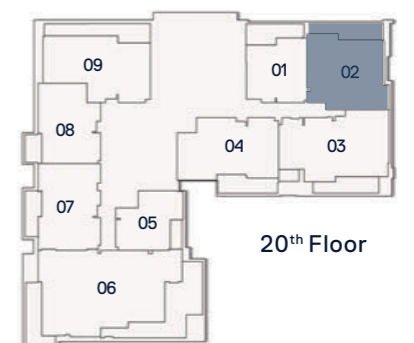
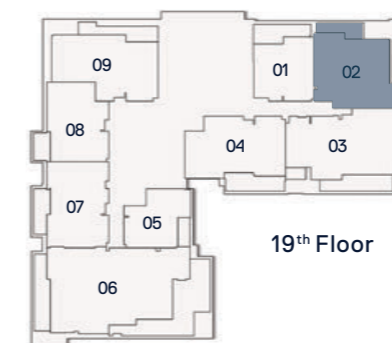
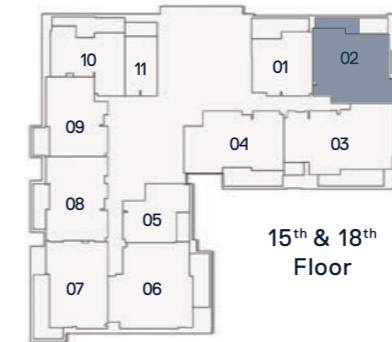
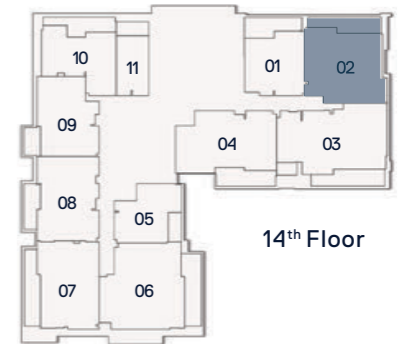
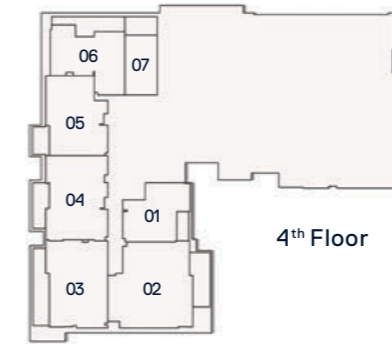

Internal Living Area
1162.93 Sq. Ft

Outdoor Living Area
116.57 Sq. Ft

Total Living Area
1279.51 Sq. Ft

2 Bedroom TYPE G

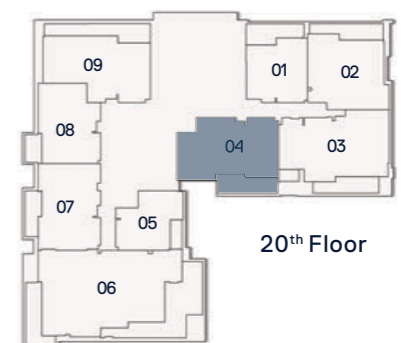
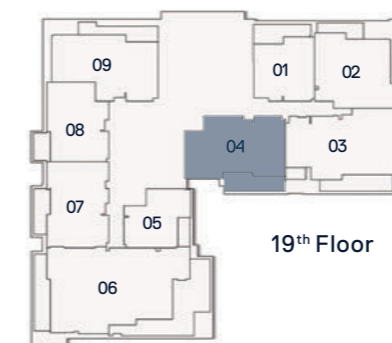
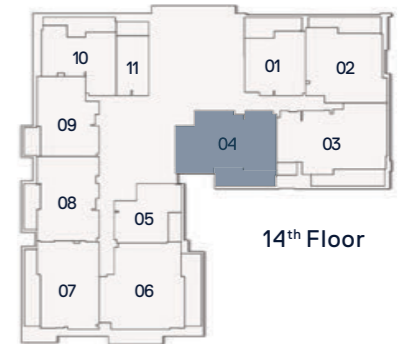
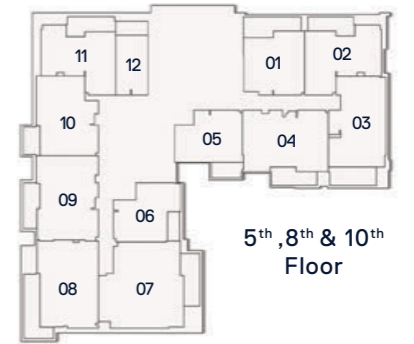
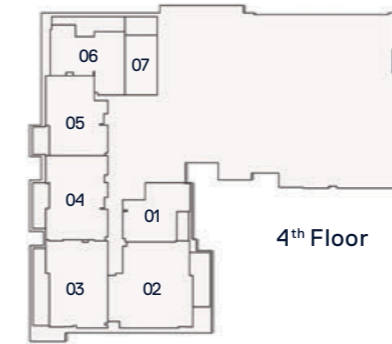

Internal Living Area

Outdoor Living Area

Total Living Area

1191.67 Sq. Ft

218.62 Sq. Ft

1410.29 Sq. Ft

2 Bedroom TYPE H

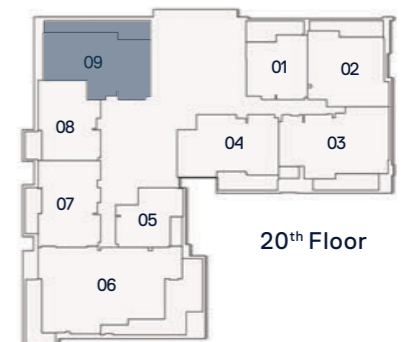
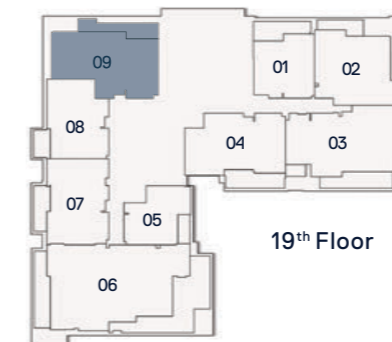
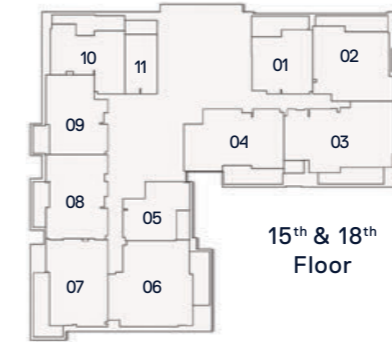
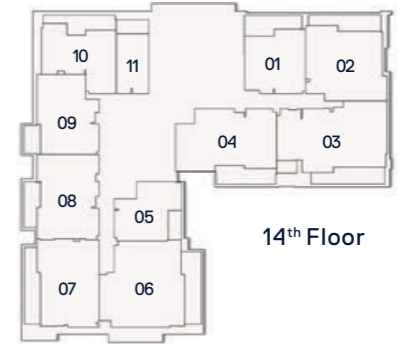
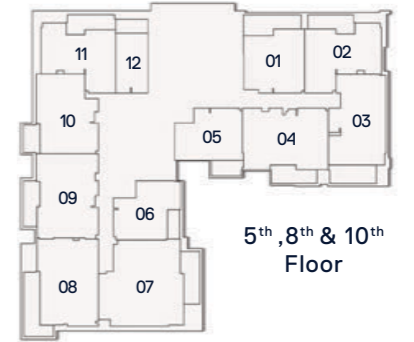
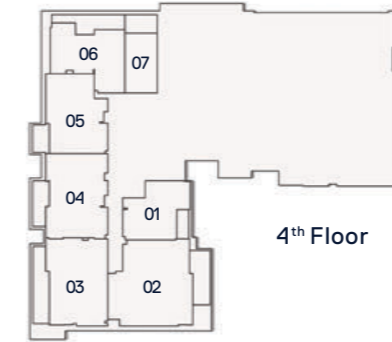

Internal Living Area

1267.99 Sq. Ft

Outdoor Living Area

211.94 Sq. Ft

Total Living Area

1479.93 Sq. Ft

3 Bedroom TYPE A

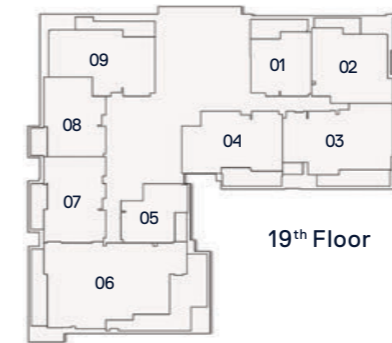
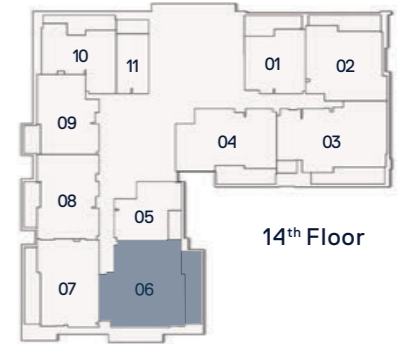
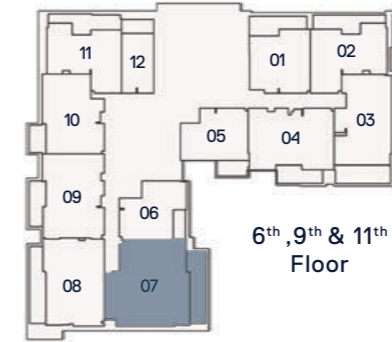
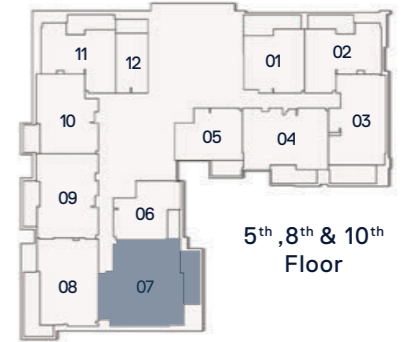
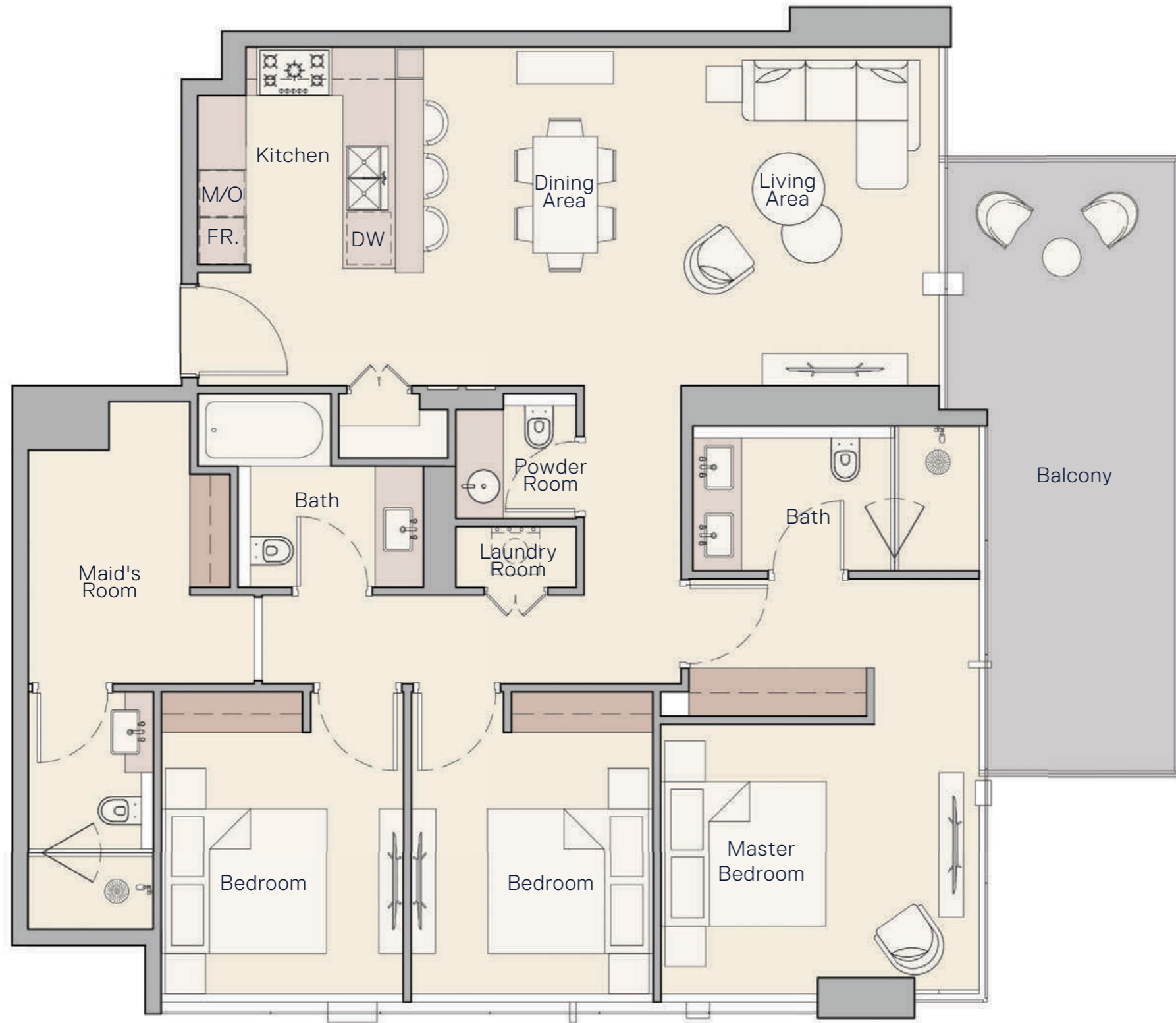

Internal Living Area
1397.37 Sq. Ft

Outdoor Living Area
196.01 Sq. Ft

Total Living Area
1593.38 Sq. Ft

3 Bedroom TYPE B

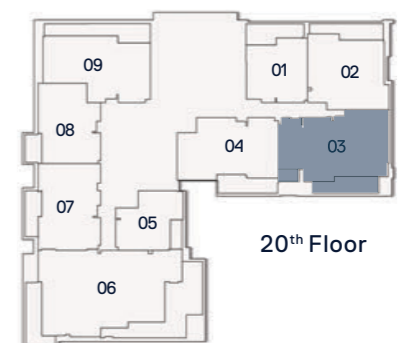
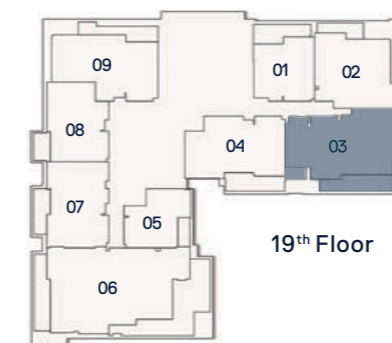
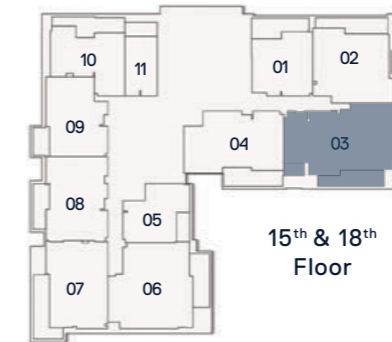
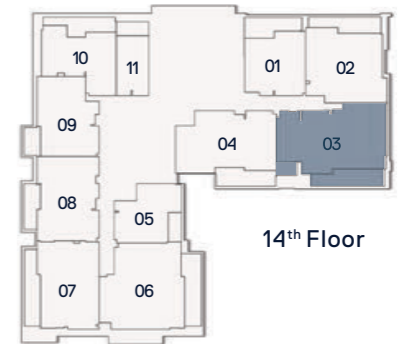
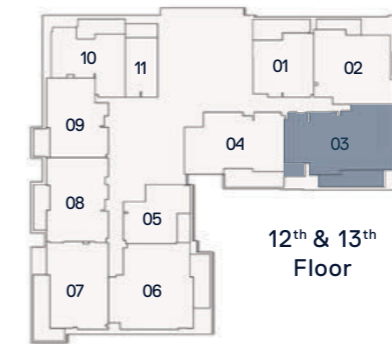
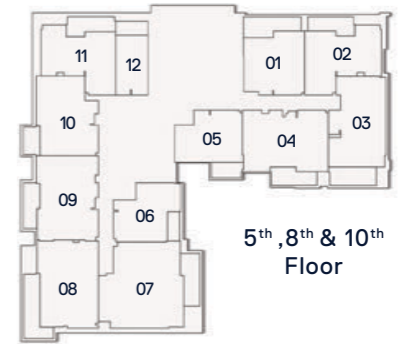
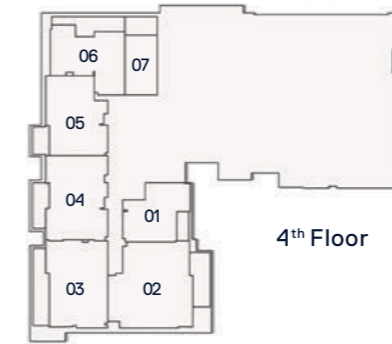

Internal Living Area
1429.66 Sq. Ft

Outdoor Living Area
283.95 Sq. Ft

Total Living Area
1713.61 Sq. Ft

3 Bedroom TYPE C

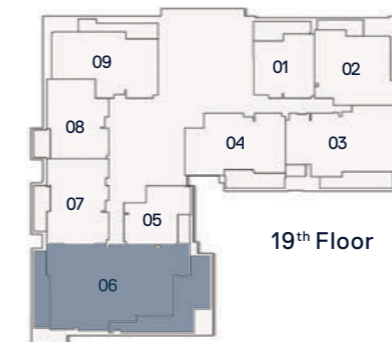
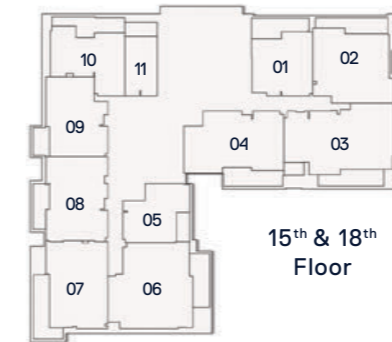
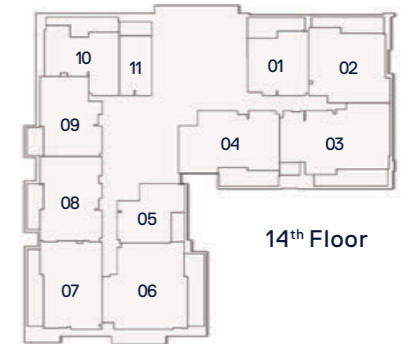
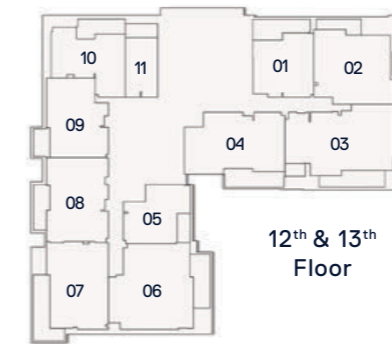
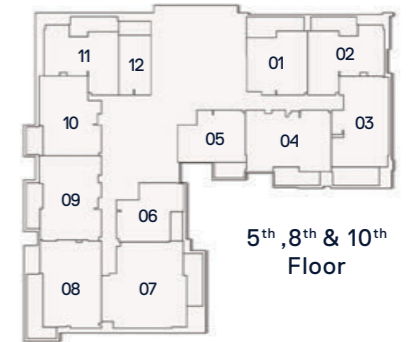
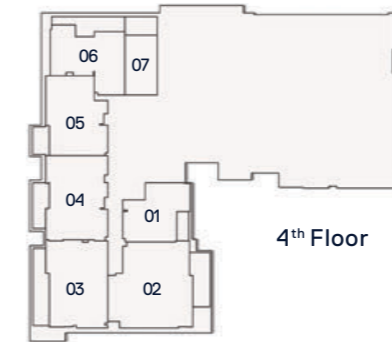

Internal Living Area
2192.29 Sq. Ft

Outdoor Living Area
888.56 Sq. Ft

Total Living Area
3080.85 Sq. Ft



TANAMI
P R O P E R T I E S

CONTACT US

 +971 4 248 3400 |  +971 55 162 3236

Email Us

info@tanamiproperties.ae

For More Info...

www.tanamiproperties.com/Projects/The-Crestmark



ADDRESS

Office 3405, Marina Plaza,
Al Marsa Street, Dubai Marina, UAE